

This product is an adapter for installing the rod holder directly to the grab handle. Be sure to refer to the "Rod Holder Installation Instructions" of the rod holder main unit when handling IF 62.

Product contents Parts ① to ⑤ and ⑧ are assembled before packing.

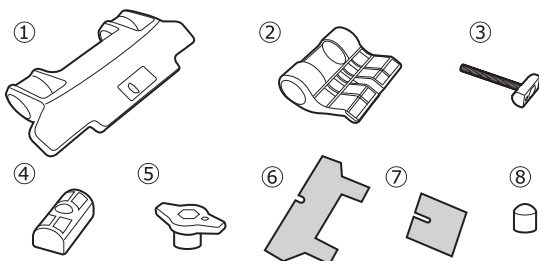

NO.	Part name	Qty
①	Clamp A	2
②	Clamp B	2
③	R-bolt	2
④	R-spacer	2
⑤	Knob	2
⑥	Protective sheet A	2
⑦	Protective sheet B	2
⑧	Bolt cap	2

Refer to this instruction manual for performing "1 Assist Pipe Installation" in the Rod Holder Stay A and stay B that are attached to the rod holder will not be used.

1 Assist Pipe Installation

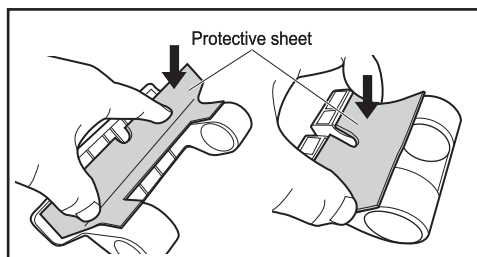

1 Attaching Protective Sheet

When the grab handle diameter is 20mm or less or to prevent leaving mounting marks left on the grab handle, attach the included protective sheets to the clamps.

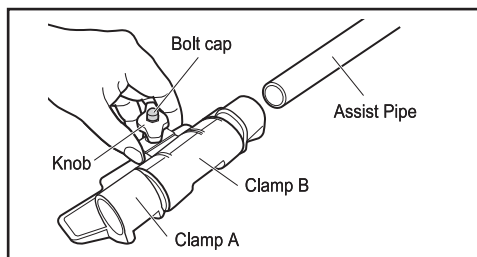

2 Assembling Assist Pipe with Clamps

Loosen the knob to align through holes of Clamp A and Clamp B, and pass the assist pipe, an accessory to the rod holder main unit.



Note

Do not loosen the knob too much or the bolt cap may come off and be lost.

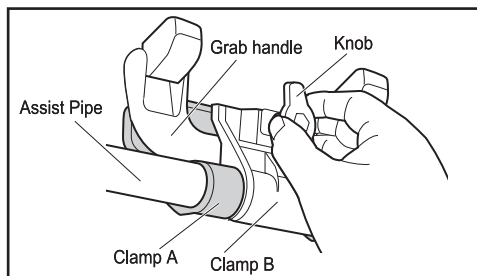

3 Mounting to Grab Handle

Temporarily tighten the knob but allow the pipe to slide.

As shown in the figure, in the standard installation method, Clamp A is under the grab handle and Clamp B is on the grab handle.



Note

Clamp positions can be reversed, but doing so lowers the assist pipe position. Therefore, install the assist pipe in the standard installation procedure unless there is a problem doing so.

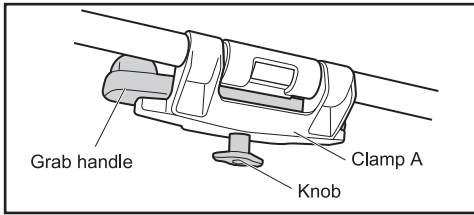

In the case that the knob touches the interior part and cannot be turned when installed in the standard way, remove the knob, insert the tightening bolt from the Clamp B side, and set the knob on the Clamp A side.

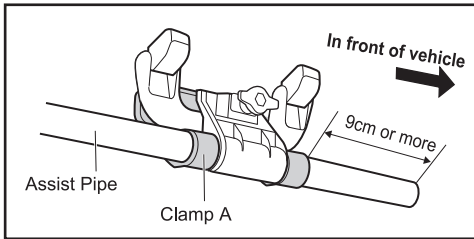

4 Projection Amount Adjustment and Tightening of Assist Pipe

Temporarily tighten the assist pipe so that the assist pipe sticks out 9cm toward the vehicle front side from Clamp A as shown in the figure.

In the case that the rear end of the assist pipe on the vehicle rear side touches the interior, slide the assist pipe toward the vehicle front side. Match the projection amount of the left and right assist pipes, and complete tightening the knob. (Tightening torque is 1N·m)

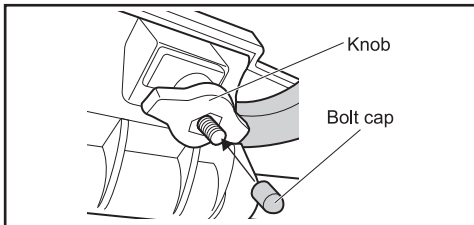

Note

A rough equivalent for 1N·m is the amount of torque applied when tightening the knob without feeling pain in your fingers.

Precautions

When the bolt end sticks out from the knob, mount a bolt cap to the bolt end.

2 How to mount the horizontal bar

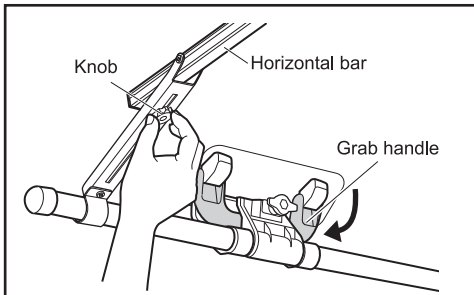

In accordance with Procedure 1, 2, and 3 in “2 How to mount the Horizontal Bar” of the Rod Holder Installation Instructions, install the horizontal bar on the front and rear sides of the assist pipe.

Retract the grab handle as much as possible, lift the horizontal bar as high as possible, and temporarily tighten the knob by making the adjuster contact the horizontal bar to become level. ※Refer to 4 of “2. How to mount the Horizontal Bar” of the main unit’s installation instructions.

Note

When the horizontal bar can be pressed against the ceiling, the maximum loading weight is 7kg.

When the horizontal bar does not reach the ceiling, installation condition is somewhat unstable. The maximum loading weight on the frame is up to 5kg.

Refer to “Rod Holder Installation Instructions” of the rod holder main unit.

Contact Information

We do not accept any liability for accidents, damage or injury caused by incorrect installation or use, modification, or natural disaster. Specifications and appearance of the carrier system and genuine replacement parts are subject to change without prior notice in the interest of product improvement.

CAR MATE USA, Inc.
 383 Van Ness Ave., Suite 1603
 Torrance, CA 90501 U.S.A.
 support@innoracks.com
 www.innoracks.com

CARMATE MFG. CO.,LTD.
 5-33-11, Nagasaki, Toshima-ku,
 Tokyo 171-0051, JAPAN
 TEL. +81(0)3 5926 1226
 int@carmate.co.jp