

ROD HOLDER

Installation instructions

Before using this product, carefully read this instruction manual for proper use.

Keep this installation instructions in a safe place.

If you are to give this product to a third person, provide him/her with this manual as well to ensure safe use.

IF14G

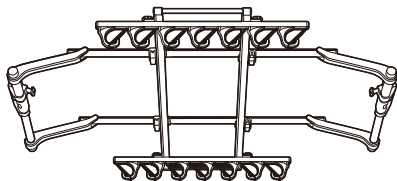

IF16G

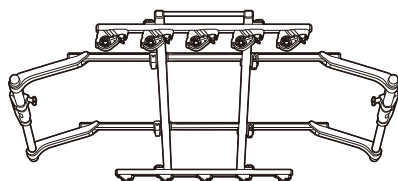

IF17G

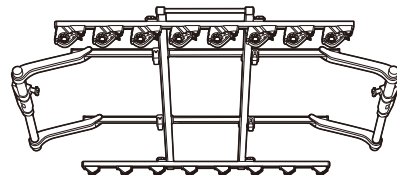

IF18G

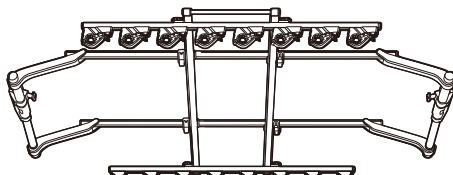

Warning Failure to follow this warning can result in serious accidents including death or serious injury.

- Should a passenger's head contact the rod holder body or rods, the passenger should not sit in that seat.
- To load rods, remove tackle such as hooks and lures or use a commercial lure cover for safety.
- This product is a rod holder for loading rods inside the vehicle. Do not use this product for anything other than its intended purposes.

Precautions Failure to follow precautions can result in injury, damage to the product, vehicle, or load.

- Do not leave rods loaded for extended periods of time. Rods may be damaged by direct sunlight or the internal temperature of the vehicle. Vibrations generated by the vehicle may result in damage or cause the rod or reel to malfunction.
- Rear viewing may be reduced depending on the vehicle model. Exercise caution when backing up the vehicle.
- Always fully tighten before and after driving.
- When the horizontal bar can be pressed against the ceiling, the maximum loading weight is 7kg. When the horizontal bar does not reach the ceiling, installation condition is somewhat unstable. The maximum loading weight on the frame is up to 5kg.

Note Before using this product, the followings should be noted.

- Do not modify this product.

Product contents

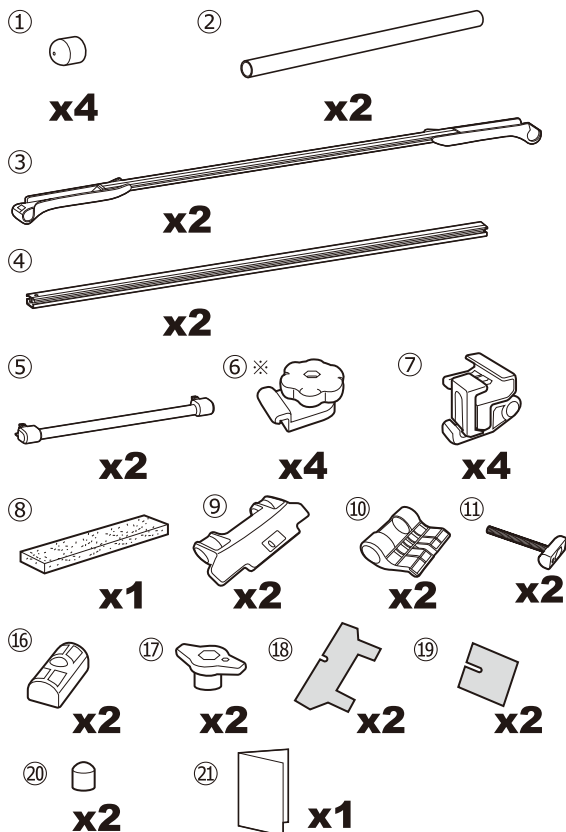

Common parts

Parts	
①	Cap
②	Assist pipe
③	Horizontal bar
④	Frame bar
⑤	Frame pipe
⑥	Clip set ※
⑦	Cross holder
⑧	Pad
⑨	Clamp A
⑩	Clamp B
⑪	R-bolt
⑫	Front Holder
⑬	Rear Holder
⑭	Rubber Band ※
⑮	Frame Molding
⑯	R-spacer
⑰	Knob
⑱	Protective sheet A
⑲	Protective sheet B
⑳	Bolt cap
㉑	Installation instructions

※ Assembled with the holder

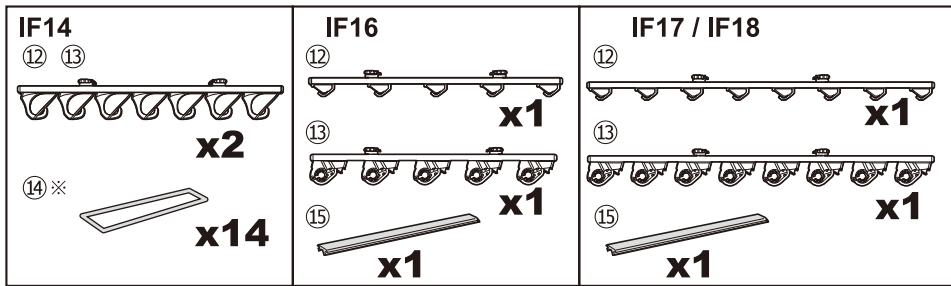

Necessary Tools for Installation

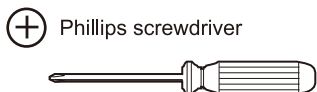

Gloves



1 Assist Pipe Installation

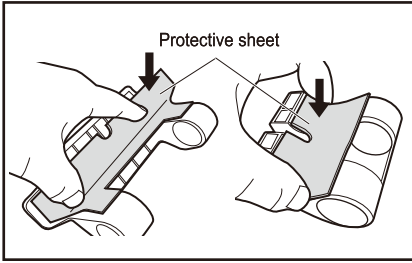

1 Attaching Protective Sheet

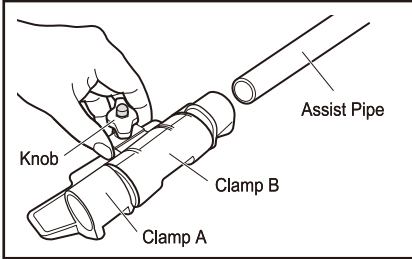

2 Assembling Assist Pipe with Clamps

Loosen the knob to align through holes of Clamp A and Clamp B, and pass the assist pipe, an accessory to the rod holder main unit.

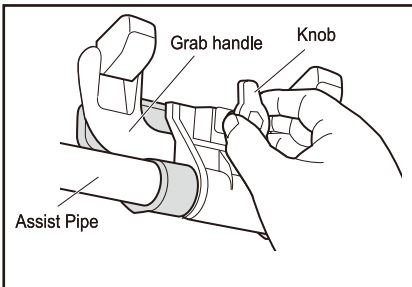

3 Mounting to Grab Handle

Temporarily tighten the knob but allow the pipe to slide.

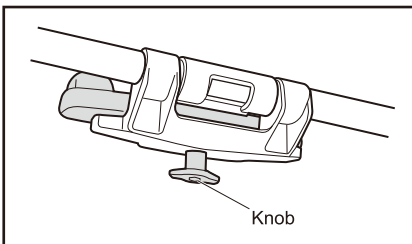

4 In the case that the knob touches the interior part and cannot be turned, turn the knob upside down.

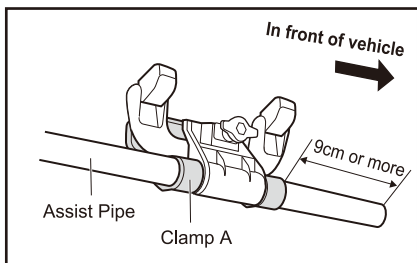

5 Projection Amount Adjustment and Tightening of Assist Pipe

Temporarily tighten the assist pipe so that the assist pipe sticks out 9cm toward the vehicle front side from Clamp A as shown in the figure. Match the projection amount of the left and right assist pipes, and complete tightening the knob. (Tightening torque is 1N·m)



A rough equivalent for 1N·m is the amount of torque applied when tightening the knob without feeling pain in your fingers.

2 How to mount the horizontal bar

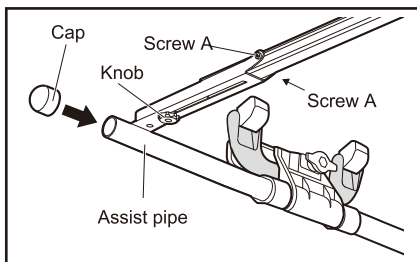

Remove the arm cover and the bracket from the horizontal bar in advance.

1 Loosen screw A and the knob, and place the arm on the assist pipe.

2 Affix caps to the assist pipes.

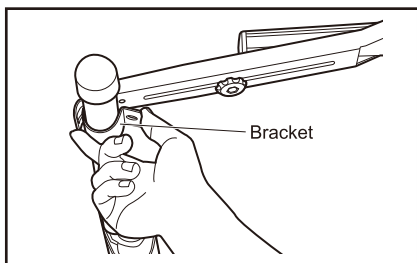

3 Mount the bracket from below, and temporarily fix in place.

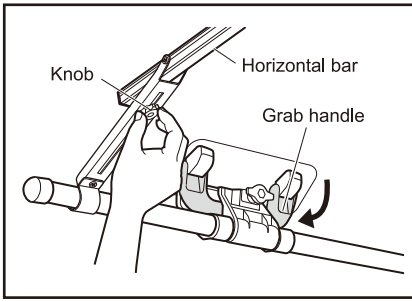

- 4** Retract the grab handle as much as possible, lift the horizontal bar as high as possible, and temporarily tighten the knob by making the adjuster contact the horizontal bar to become level.



When the horizontal bar does not reach the ceiling, installation condition is somewhat unstable. The maximum loading weight on the frame is up to 5kg.

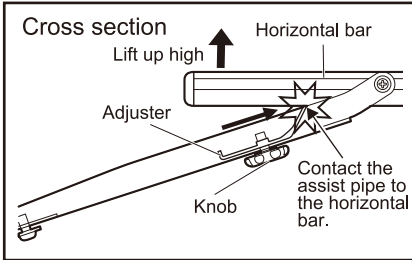

When the adjuster does not enter below the horizontal bar, take it out, change the direction, and temporarily fix the knob in place.

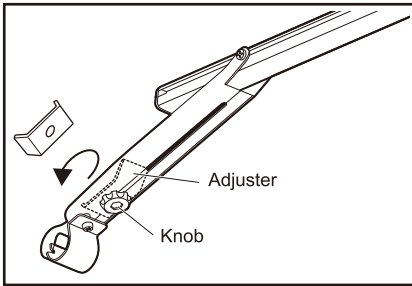

3 Holder Assembly (※Preliminary work is not necessary for the J hook type.)

Preliminary work (For dual hold type)

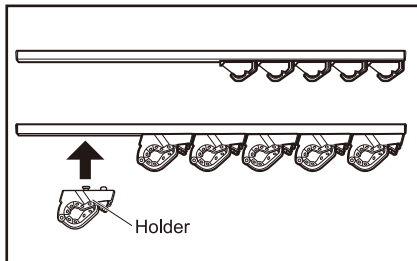

Decide on the number and position of holders based on the purpose.

Note

To add a holder, purchase separately sold IF50BK optional holder DH.

【Removing holders】

Rotate the front holder by 90 degrees to remove from the holder frame.

Rotate the rear holder by 90 degrees while pressing the release switch to remove.

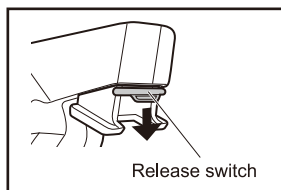
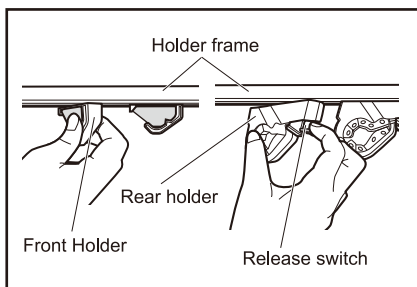

【Mounting holders】

Insert the upper holder at the right angles to the space of the holder frame, and rotate it by 90 degrees to mount.

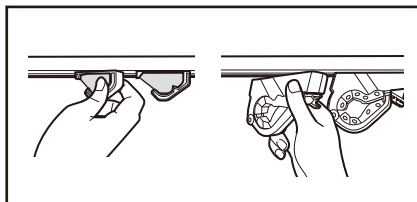

【Mounting frame molding】

Cut the frame molding with scissors to fill in the left space of the holder frame.

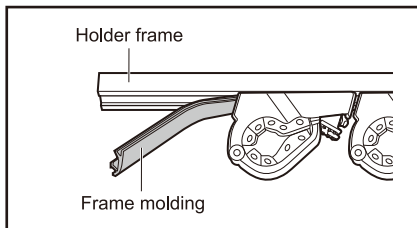

4 Assembly of frame bar

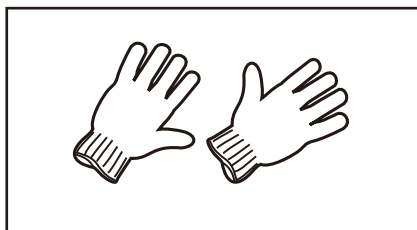

Precautions

Always wear gloves when assembling the rack. The aluminum edges may injure your hand or fingers.

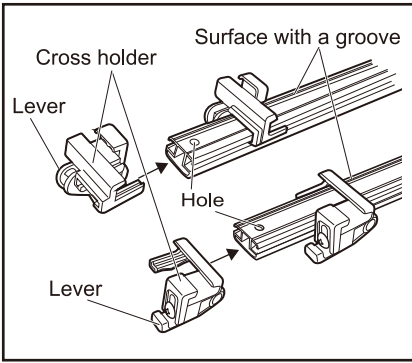

Fit 2 cross holders in the frame bars by making the levers stay outside the frame bars.

⚠ Precautions

Do not mount the levers of the cross holders inside the frame bars. Doing so weakens the fixing strength.

👉 Note

Face the surfaces with holes and grooves of the frame bars up.

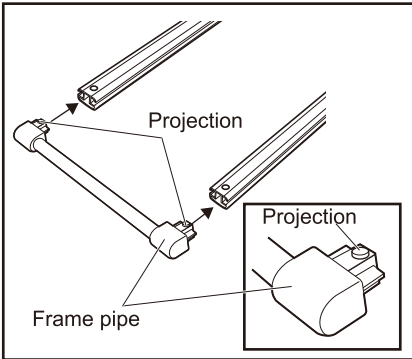

Match the projection of the frame cap to the hole of the frame bar to insert.

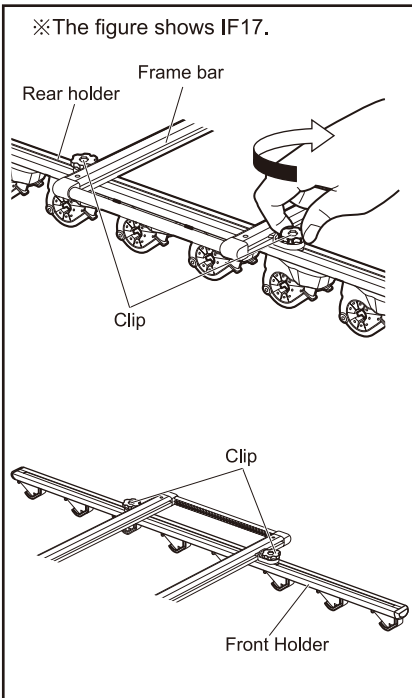

Fix the front and rear holders with clips from outside the frame bars.

⚠ Precautions

Do not mount the clips inside the frame bars. Doing so weakens the fixing strength.

👉 Note

Mount the holder by facing the groove side of the frame bar up.

👉 Note

For J hook type holders, face the front and rear holder in the reverse direction to mount.

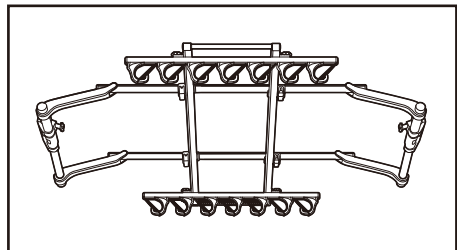

5 How to mount frames

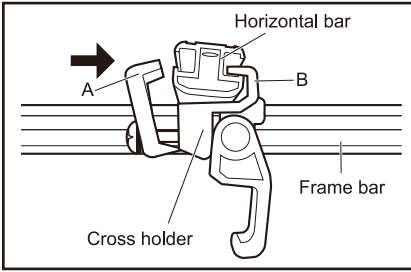

1-1 Loosen the levers in 4 places of the cross holder to move A downward.
Adjust in front and behind the cross holder, and insert B into the groove of the horizontal bar.

1-2 Lift A and insert it into the horizontal bar groove.

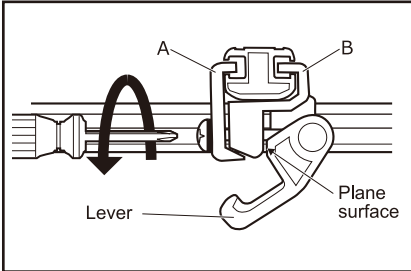

2-1 With the plane surface of the lever corner contacted to the cross holder, turn the adjustment screw using a Phillips-head screwdriver until there is resistance.

Precautions

Tightening the adjustment screw without the plane surface of the lever contacting the cross holder may apply excessive force to the lever resulting in damage.

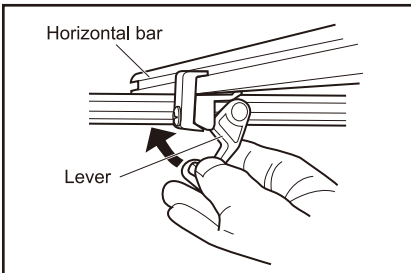

2-2 Close the lever .

Note

When the lever is loose or too tight to fasten, adjust the adjustment screw using a Phillips screwdriver.

Precautions

Do not drive the vehicle with the levers open.

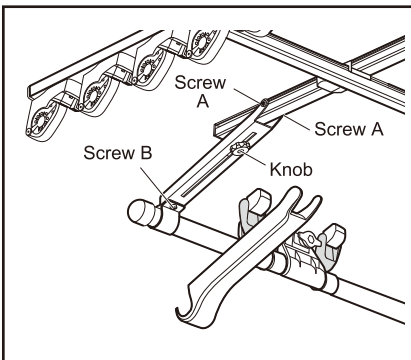

3 To adjust the horizontal bar height to make it as high as possible using the adjuster, paste the pad to the place contacting the lining, and tighten all screws.

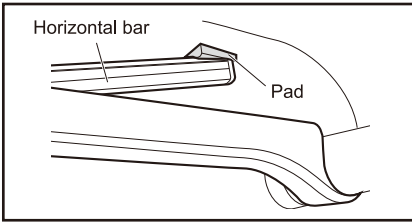

Note
Cut the included pad and paste it to the contact place between the horizontal bar edge and the lining to reduce the damage to the lining.

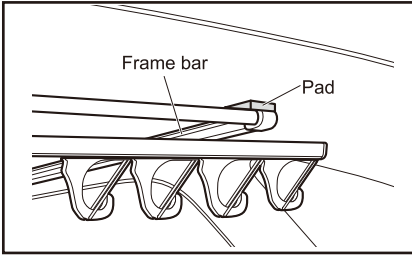

Note
Depending on the vehicle model, the rear holder edge on rare occasions as well as the frame bar contact the lining. In that case, cut the included pad and paste to the place to which the frame bar or the rear holder contacts.

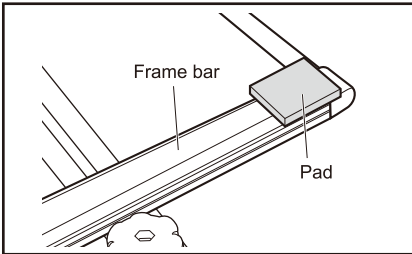

6 How to load the rod

For J hook type

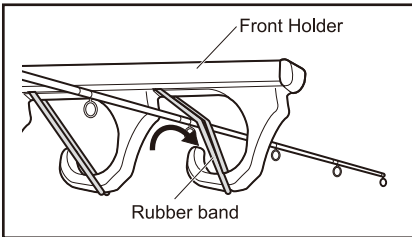

Push the rubber bands in the order of front and rear to hook to the bottom of the hook.



Note
If the tip is too thin causing rattling when loading the one piece rod, paste the included pad to the hook as shown in the figure.

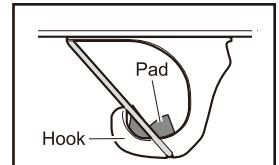
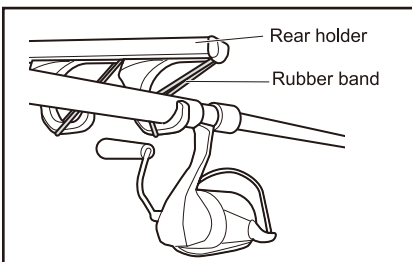

- Precautions**
- Fishing rod tips are easily damaged, so handle the rod with care.
 - Bundle rod sections with a rod belt, etc. to load jointed fishing rod.
 - Apply a cover to the telescopic extension rod end before loading.

For dual hold type

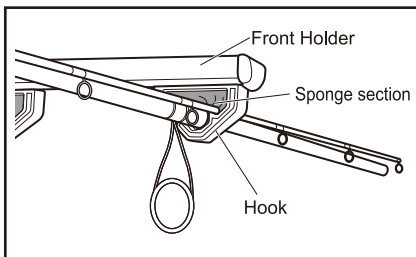

Insert the rod to the sponge section of the front holder.



Standard loading position is the tip side on the right and the grip side on the left.



Press the button to open the rear holder. Place the rod, and close it until it clicks.



Standard loading position is the tip side on the right and the grip side on the left.

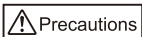
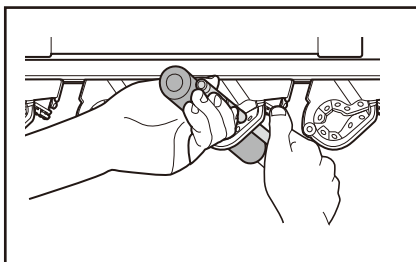
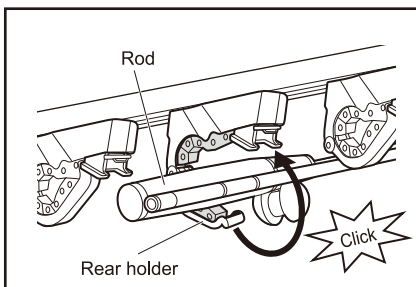
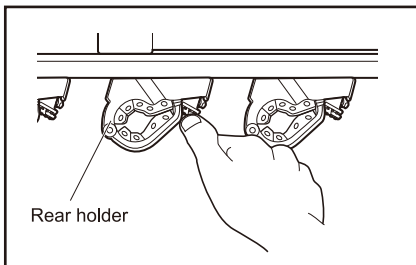
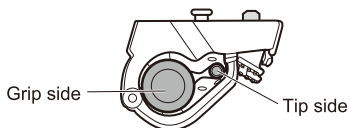

When unloading the rod, always hold the grip end with a hand, and press the button with the other hand to remove. If the button is pressed first, the rod may drop or the product may be damaged.



When reels touch each other, load reels to the front and back of the rear holders alternately.

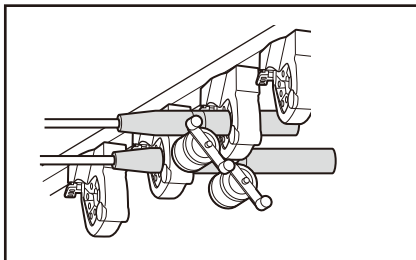

7 How to clean

- Wipe dirt off using a soft damp cloth and dry the product in the shade.
- Doing the following may cause discoloration or cracking of the product. Refrain from using them.
 - Use of detergents (especially alkali detergent) or wax
 - Use of solvents such as thinner
 - Oiling screws or bolts

Repair parts

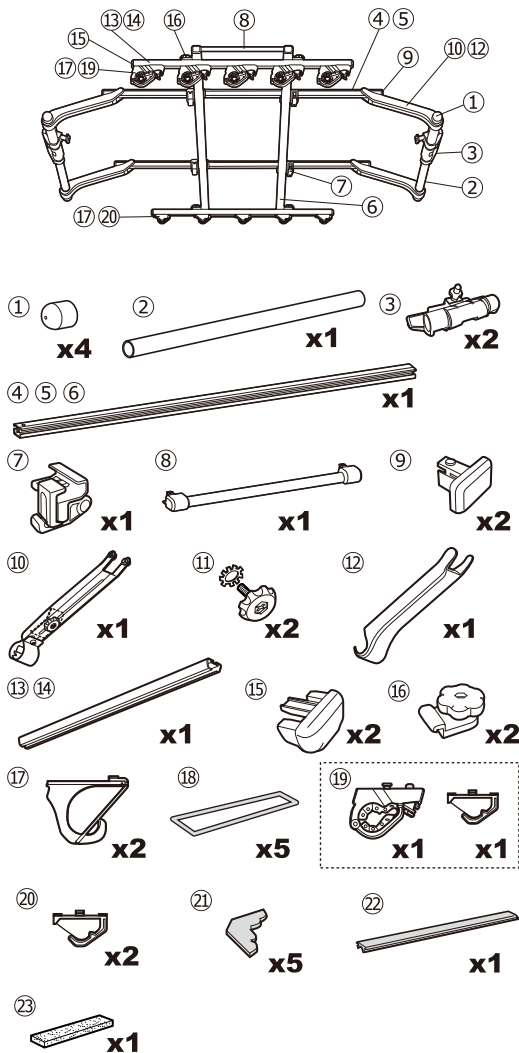

No	Parts
①	ZSP55
②	ZSP52
③	IF62
④	ZSP80
⑤	ZSP81
⑥	ZSP82
⑦	ZSP88
⑧	ZSP83
⑨	ZSP84
⑩	ZSP85
⑪	ZSP86
⑫	ZSP87
⑬	ZSP89
⑭	ZSP90
⑮	ZSP92
⑯	ZSP91
⑰	ZSP93
⑱	ZSP24
⑲	IF50BK
⑳	ZSP73
㉑	ZSP74
㉒	ZSP75
㉓	ZSP94

Contact Information

We do not accept any liability for accidents, damage or injury caused by incorrect installation or use, modification, or natural disaster. Specifications and appearance of the carrier system and genuine replacement parts are subject to change without prior notice in the interest of product improvement.

CAR MATE USA, Inc.

383 Van Ness Ave., Suite 1603
Torrance, CA 90501 U.S.A.
support@innoracks.com
www.innoracks.com

CAR MATE MFG. CO., LTD.

5-33-11, Nagasaki, Toshima-ku,
Tokyo 171-0051, JAPAN
TEL.+81(0)3 5926 1226
int@carmate.co.jp