

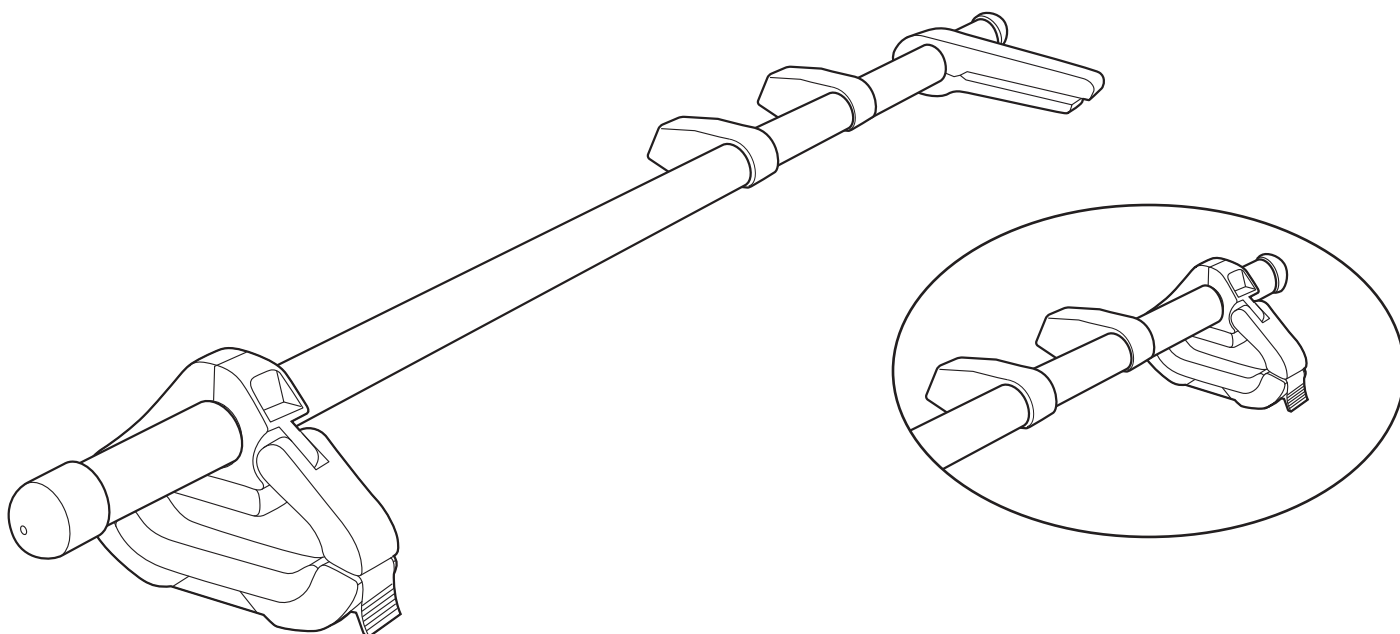

# IF9 Installation Instructions

Before using this product, carefully read this instruction manual for proper use. Keep this installation instructions in a safe place. If you are to give this product to a third person, provide him/her with this manual as well to ensure safe use.



**Warning** Failure to follow this warning can result in serious accidents including death or serious injury.

- This product can be installed only to specified vehicle models. Be sure to check the chart that applies to your vehicle model.
- Should a passenger's head contact the rod holder body or rods, the passenger should not sit in that seat.
- To load rods, remove tackle such as hooks and lures or use a commercial lure cover for safety.
- This product is a rod holder for loading rods inside the vehicle. Do not use this product for anything other than its intended purposes.

**Precautions** Failure to follow precautions can result in injury, damage to the product, vehicle, or load.

- Do not leave rods loaded for extended periods of time. Rods may be damaged by direct sunlight or the internal temperature of the vehicle. Vibrations generated by the vehicle may result in damage or cause the rod or reel to malfunction.
- Rear viewing may be reduced depending on the vehicle model. Exercise caution when backing up the vehicle.
- Always fully tighten before and after driving.
- Maximum load capacity : 2.3 lbs or 1 kg. (For safety, be sure not to exceed maximum load capacity.)

**Note** Before using this product, the followings should be noted.

- Do not modify this product.

## Product contents

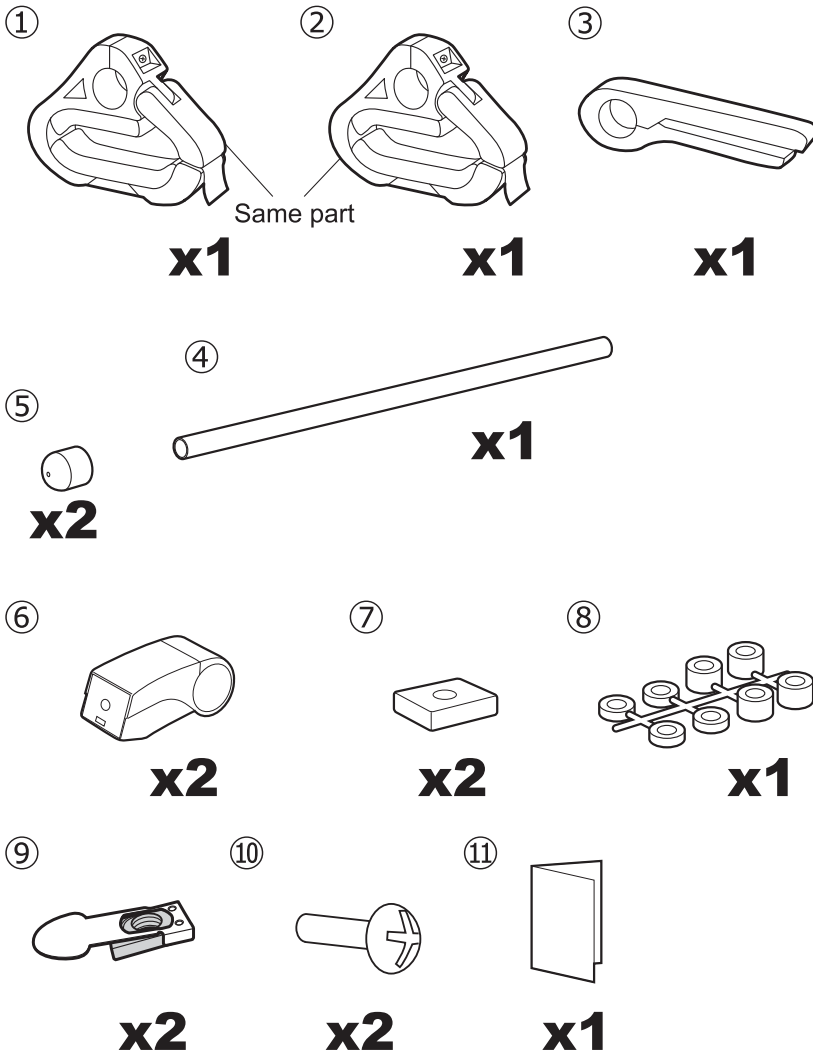

No	Parts
①	Rear Holder
②	Front Holder (For telescoping rod)
③	Front Holder (For 1 piece rod)
④	Assist pipe 39 3/8 inch (1000 mm)
⑤	Cap
⑥	Stay
⑦	Spacer 1
⑧	Spacer 2 · 3 set
⑨	In-pull nut
⑩	Mounting screw (M6X30)
⑪	Installation instructions

### Necessary Tools for Installation

⊕ Phillips screwdriver



## 1 Assist Pipe Installation

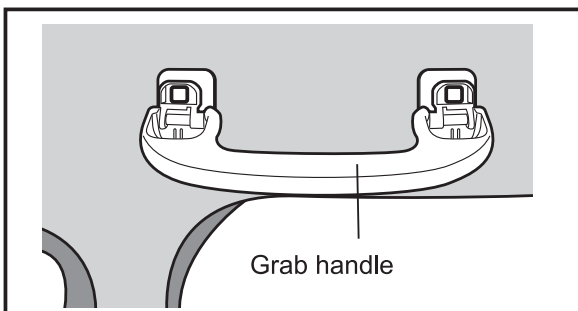

1 Remove the second or third seat grab handles.

Note

•If unable to remove the grab handle, please contact your dealer for removal instructions.

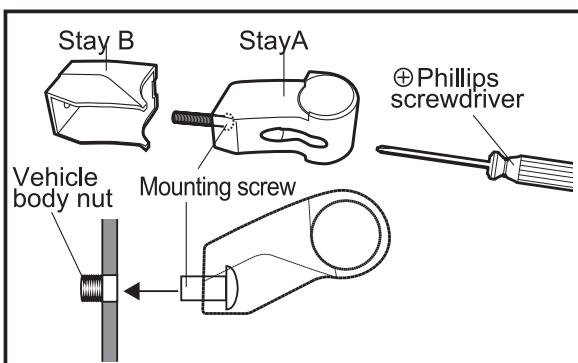

2-1 When the grab handle is a screw mounted type

Insert the mounting screw, which was removed in procedure 1, into Stay A, and put Stay A into Stay B. To temporarily hold the stay on to the vehicle body, insert the mounting screw into the nut, then tighten the mounting screw with Phillips screwdriver.

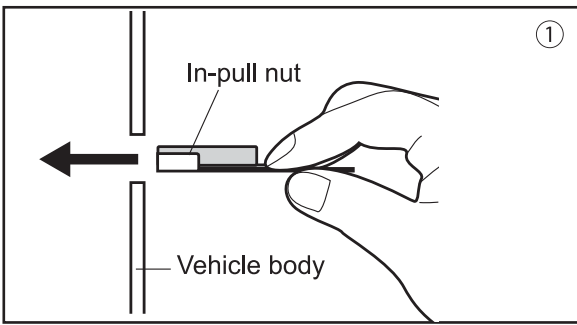

2-2 When the grab handle is a square hole mounted type

① Mount the included in-pull nut as shown in the figure.

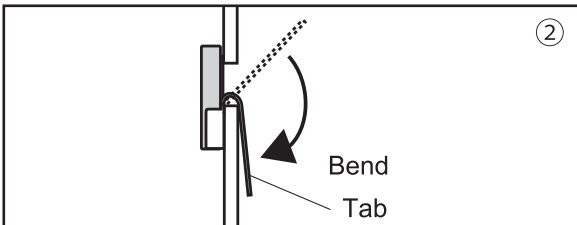

② Bend the tab as shown in the figure.

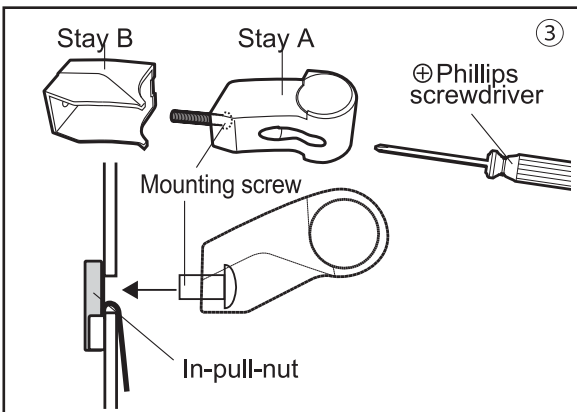

③ Insert the included mounting screw into Stay A, and put Stay A into Stay B. To temporarily hold the stay on to the vehicle body, insert the mounting screw into the in-pull nut, then tighten the mounting screw with Phillips screwdriver.

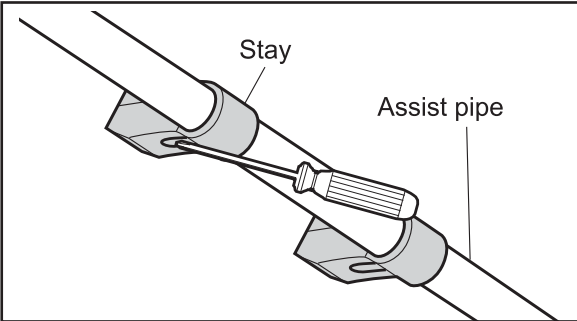

3 Put the assist pipe (39 3/8 inch or 1000mm) through the stay from the side and temporarily fix the stay with the pipe.

Temporarily tighten the mounting screw to prevent the pipe from rattling while allowing the pipe to slide.

Securely tighten the screw once the front and rear holder positions are set.

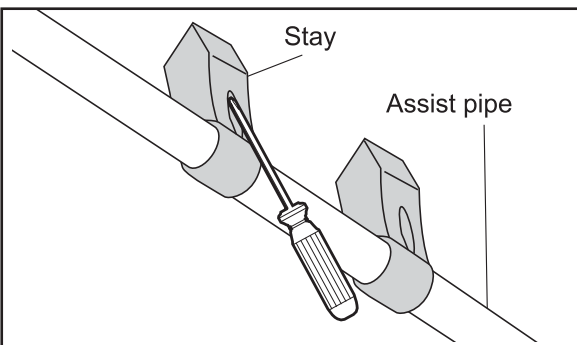

**Note**

- When the pipe touches the interior or when a hand cannot be inserted in the space between the headlining and the pipe due to lack of room, install the stay upside down or insert Spacer 1 and tighten the screw.

**Note**

- When the bar is loose due to insufficient tightening with a long screw or when the horizontal bar length is insufficient due to a wide vehicle width, insert Spacer 1 and tighten the screw. If the interior holes are too big and causing rattling, insert Spacer 2 or 3 and tighten the screw.

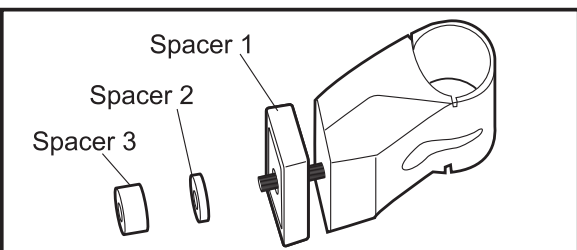

## 4 How to mount the rear holder

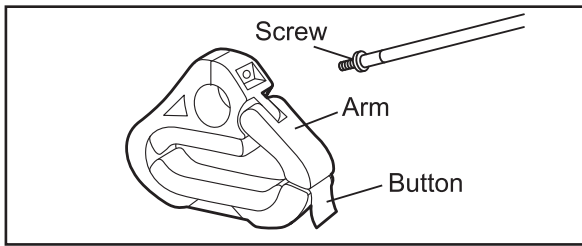

1 Remove the screw and press the button to open the arm.

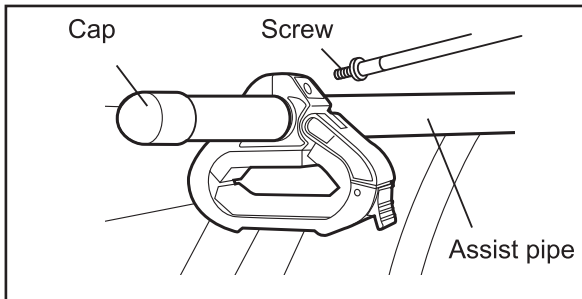

2 Attach the rear holder towards the back of the assist pipe using the removed screw in the previous procedure.

**⚠ Precautions** • Confirm that the rod grip is not touching the tailgate.

3 Put the cap on the rear end of the assist pipe.

## When loading one-piece rods

### 5 -1 How to mount the front holder

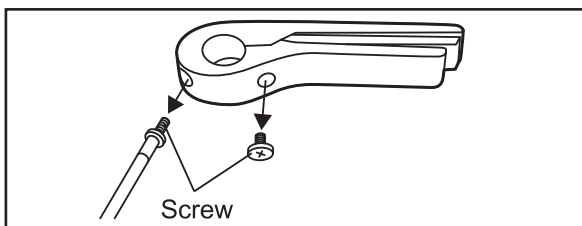

1 Remove the screws in 2 places.

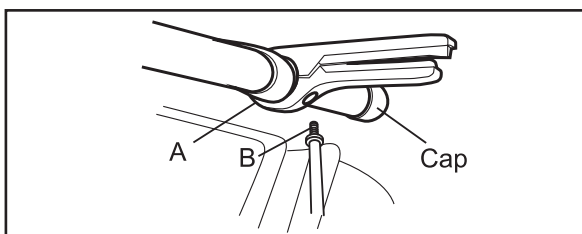

2 Attach the front holder towards the front end of the assist pipe and tighten screw A first, then B.

**👉 Note**

• If the tip comes off easily, B first and then A.

3 Put the cap on the front end of the assist pipe.

### 5 -2 How to load the rod

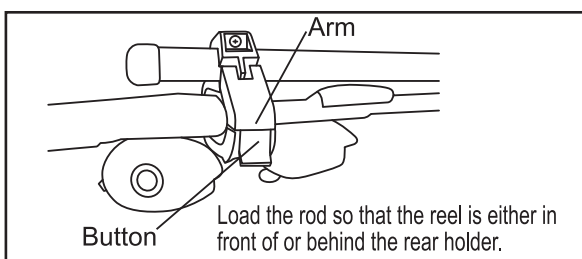

1 Press the button of the rear holder to open the arm, and slide the rod into the holder.

**👉 Note**

• If the loaded reels contact each other, stagger the rods.

2 Hold down the arm to close until a click is heard.

3 Insert the rod between the sponge of the front holder.

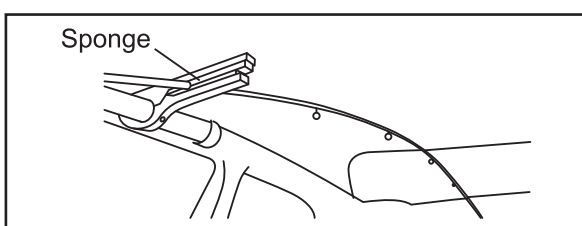

**⚠ Precautions**

## When the tip exceeds the front holder

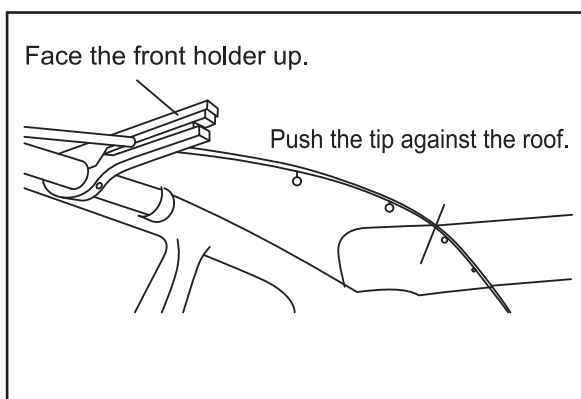

- 1 Loosen the front holder screw.
- 2 Face the front holder up, and adjust the rod at an angle that the tip can be pushed against the roof.

**👉 Note**

- Before pushing the tip against the roof, attach a commercial sponge, etc. to the car body to prevent damage.

## When loading a telescoping rod

### 6 -1 How to load the rod

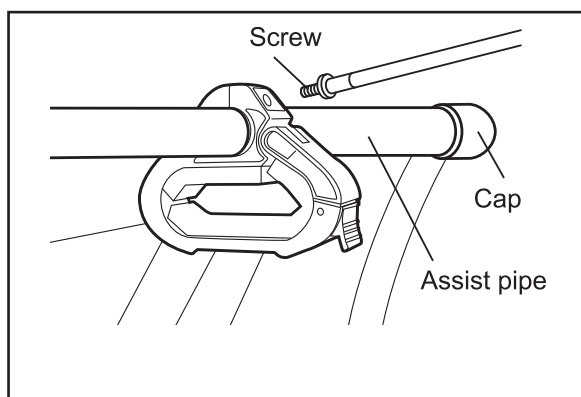

- 1 The front holder for the telescoping rod is the same part as the rear holder. Mount it in the front end of the assist pipe. Refer to step 4 "How to mount the rear holder" for mounting method.

### 6 -2 How to load the rod

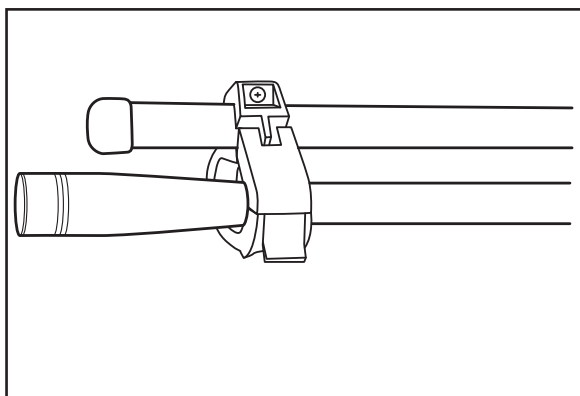

- 1 Press the buttons of the front and rear holders to open the arms, and slide the rod into the holder.
- 2 Hold down the arm until a click is heard.

### 7 How to clean

- Wipe dirt off using a soft damp cloth and dry the product in the shade.
- Doing the following may cause discoloration or cracking of the product. Refrain from using them.
  - Use of detergents (especially alkali detergent) or wax
  - Use of solvents such as thinner
  - Oiling screws or bolts

# Repair parts

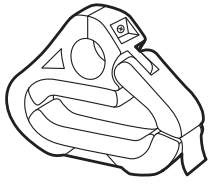

**x1**

Front / Rear holder



**x1**

Front Holder  
(For 1 piece rod)

IF54  
Option 3 holder



**x2**

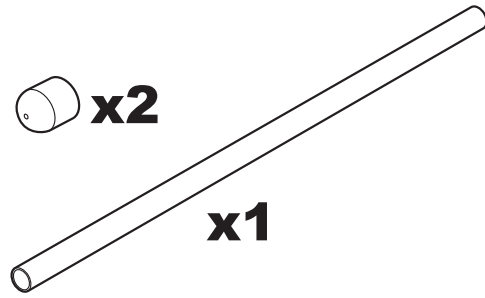

**x1**

ZSP53  
Assist pipe 39 3/8 inch (1000 mm)  
(With 2 caps)

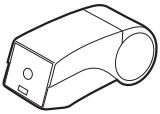

**x1**

ZSP28  
Stay



**x4**

ZSP43  
Mounting screw  
(M6X30)



**x4**

ZSP55  
Cap

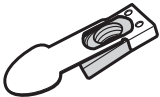

**x1**

Inpull nut

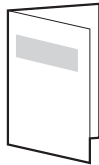

**x1**

Installation  
instructions



**x4**

**x1**

ZSP38  
Spacer set



## Contact Information

We do not accept any liability for accidents, damage or injury caused by incorrect installation or use, modification, or natural disaster. Specifications and appearance of the carrier system and genuine replacement parts are subject to change without prior notice in the interest of product improvement.

### **CAR MATE USA, Inc.**

383 Van Ness Ave., Suite 1603  
Torrance, CA 90501 U.S.A.  
support@innoracks.com  
www.innoracks.com

### **CARMATE MFG. CO.,LTD.**

5-33-11, Nagasaki, Toshima-ku,  
Tokyo 171-0051, JAPAN  
TEL.+81(0)3 5926 1226  
int@carmate.co.jp