

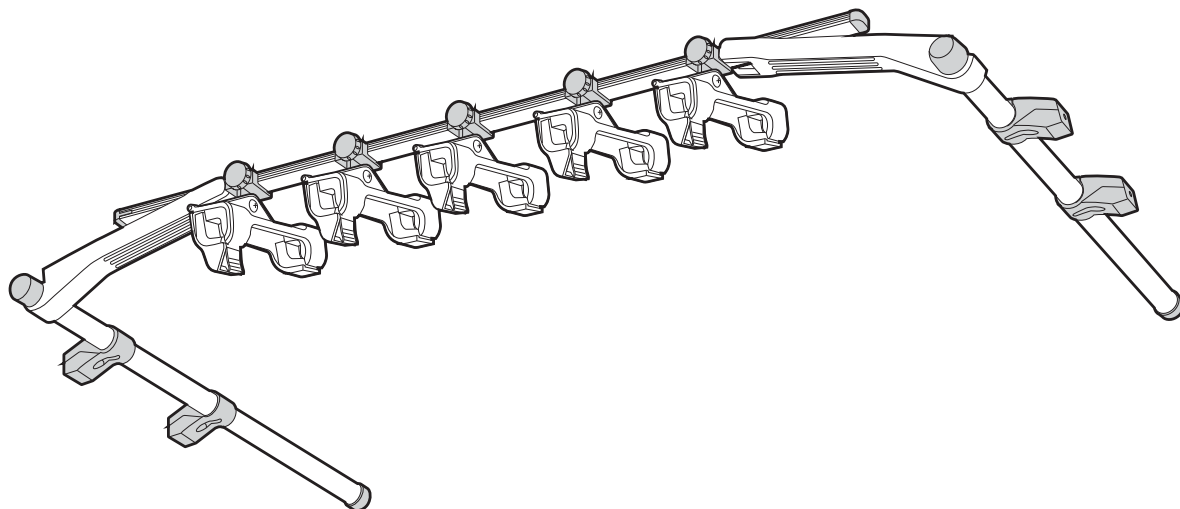

IF1 Installation Instructions

Before using this product, carefully read this instruction manual for proper use.

Keep this installation instructions in a safe place. If you are to give this product to a third person, provide him/her with this manual as well to ensure safe use.



Warning Failure to follow this warning can result in serious accidents including death or serious injury.

- This product can be installed only to specified vehicle models. Be sure to check the chart that applies to your vehicle model.
- Should a passenger's head contact the rod holder body or rods, the passenger should not sit in that seat.
- To load rods, remove tackle such as hooks and lures or use a commercial lure cover for safety.
- This product is a rod holder for loading rods inside the vehicle. Do not use this product for anything other than its intended purposes.

Precautions Failure to follow precautions can result in injury, damage to the product, vehicle, or load.

- Do not leave rods loaded for extended periods of time. Rods may be damaged by direct sunlight or the internal temperature of the vehicle. Vibrations generated by the vehicle may result in damage or cause the rod or reel to malfunction.
- Rear viewing may be reduced depending on the vehicle model. Exercise caution when backing up the vehicle.
- Always fully tighten before and after driving.
- Maximum load capacity of the frame section: 11lbs or 5kg. (For safety, be sure not to exceed maximum load capacity.)

Note Before using this product, the followings should be noted.

- Do not modify this product.

Product contents

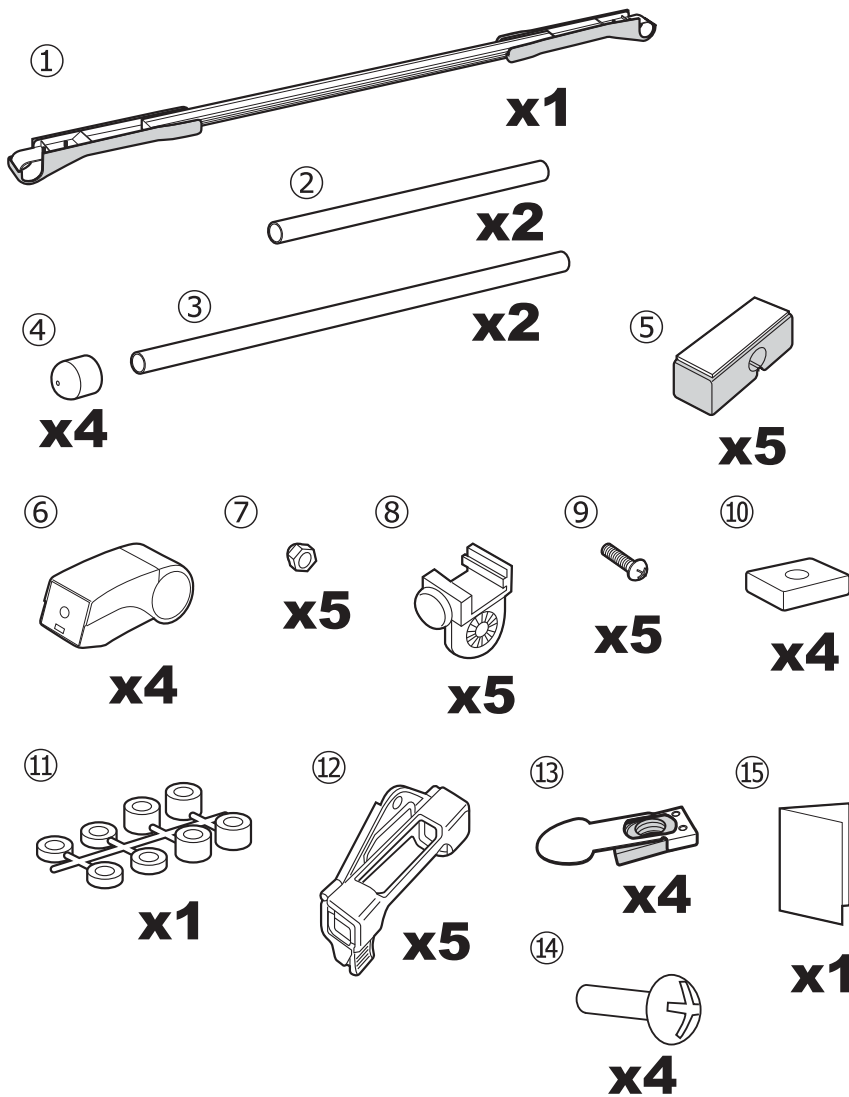

No	Parts
①	Horizontal bar
②	Assist pipe 23 5/8 inch (600 mm)
③	Assist pipe 39 3/8 inch (1000 mm)
④	Cap
⑤	Tip cushion
⑥	Stay
⑦	Cap nut
⑧	Clamp
⑨	Truss head screw
⑩	Spacer ①
⑪	Spacer ②·③ set
⑫	Rear holder
⑬	In-pull nut
⑭	Mounting screw (M6X30)
⑮	Installation instructions

Necessary Tools for Installation

⊕ Phillips screwdriver



1 Assist Pipe Installation

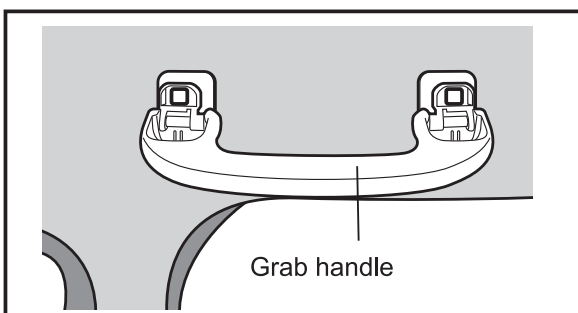

1. Remove the second or third seat grab handles.



• If unable to remove the grab handle, please contact your dealer for removal instructions.

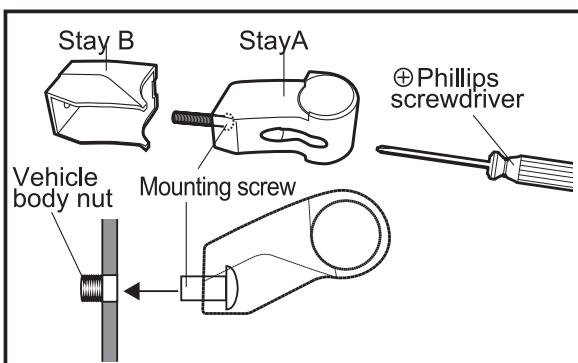

2-1 When the grab handle is a screw mounted type

Insert the mounting screw, which was removed in procedure ①, into Stay A, and put Stay A into Stay B. To temporarily hold the stay on to the vehicle body, insert the mounting screw into the nut, then tighten the mounting screw with Phillips screwdriver.

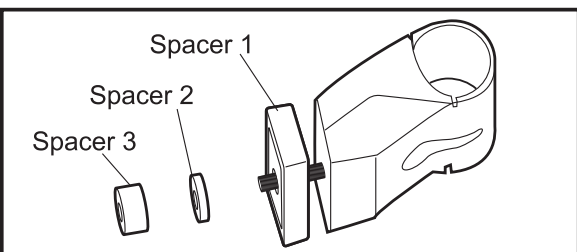
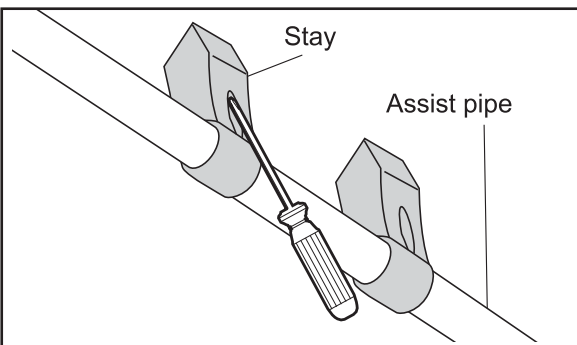
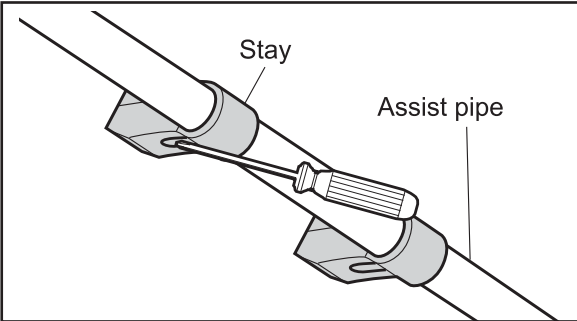
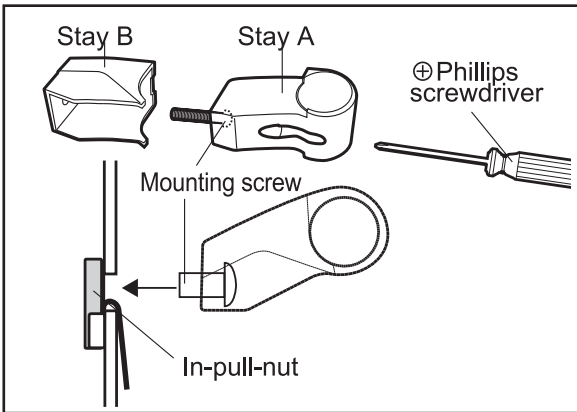
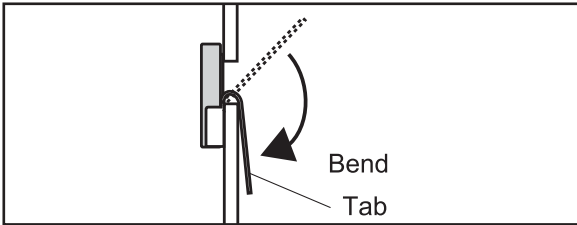
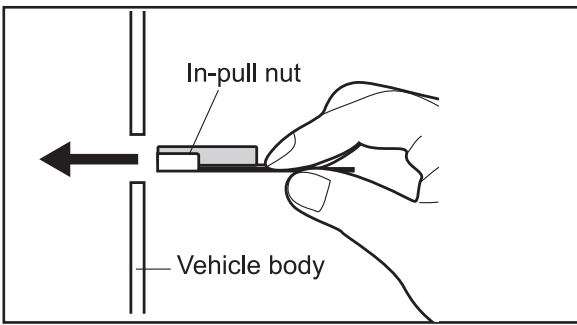

2-2 When the grab handle is a square hole mounted type

① Mount the included in-pull nut as shown in the figure.

② Bend the tab as shown in the figure.

③ Insert the included mounting screw into Stay A, and put Stay A into Stay B. To temporarily hold the stay on to the vehicle body, insert the mounting screw into the in-pull nut, then tighten the mounting screw with Phillips screwdriver.

3. Put the assist pipe (39 3/8 inch or 1000mm) through the stay from the side and temporarily fix the stay with the pipe.

If the assist pipe is too long and contacts the interior, etc., replace with the 23 5/8 inch (600mm) assist pipe.

Temporarily tighten the mounting screw to prevent the pipe from rattling but allowing the pipe to slide backward and forward.

Note

- When the pipe touches the interior or when a hand cannot be inserted in the space between the headlining and the pipe due to lack of room, install the stay upside down or insert Spacer ① and tighten the screw.

Note

- When the bar is loose due to insufficient tightening with a long screw or when the horizontal bar length is insufficient due to a wide vehicle width, insert Spacer ① and tighten the screw. If the interior holes are too big and causing rattling, insert Spacer ② or ③ and tighten the screw.

2 Horizontal Bar Installation

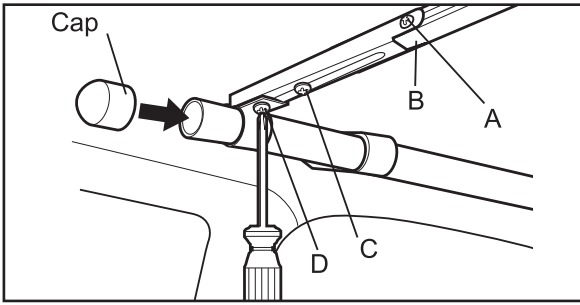

1. Loosen Screw A, B, C, and D on the horizontal bar, mount the horizontal bars at the front and rear parts of the assist pipe, and temporarily tighten Screw D.

2. Affix caps to the assist pipes.

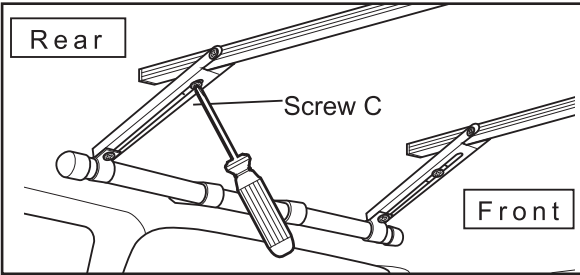

3. Raise the horizontal bars as high as possible. Make the adjuster contacts the bar so the horizontal bar becomes parallel with the roofline. Temporarily tighten Screw C.

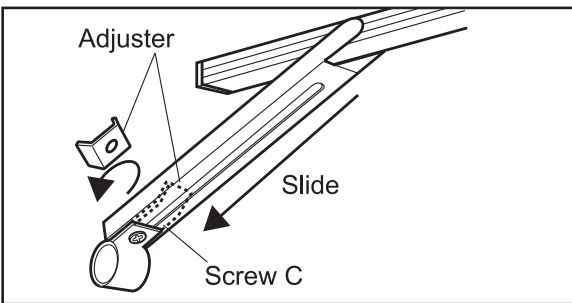
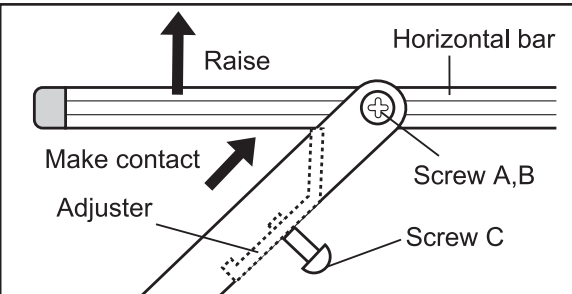

Note

● If the adjuster does not fit under the horizontal bar, remove the adjuster, reverse the direction, and temporarily tighten Screw C.

3 Rear Holder Installation

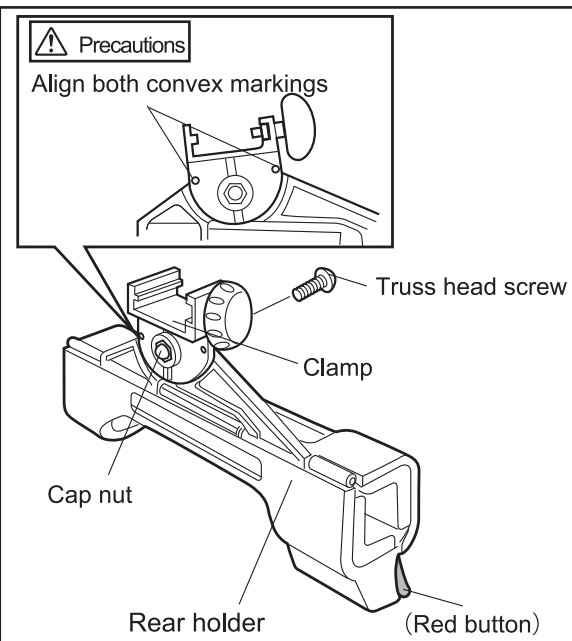

1. Assemble the clamps on all rear holders.

Precautions

● Confirm the mounting angle by aligning both convex markings on the clamps. The standard angle is obtained when the both convex marking are aligned.

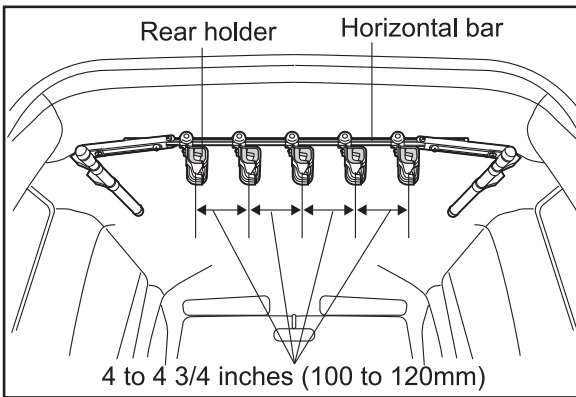
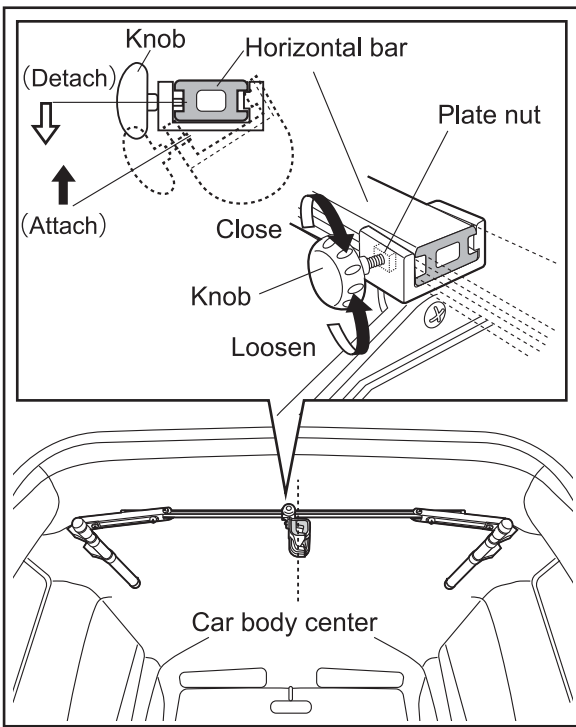

4 Securing each part

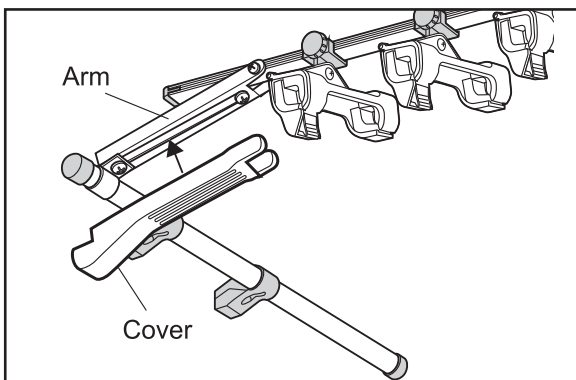
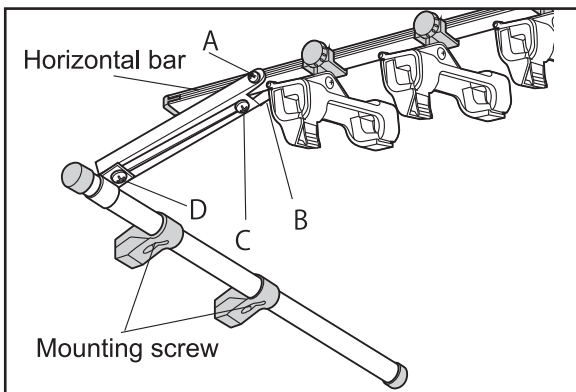

2. Mount a rear holder to the center of the horizontal bar.

⚠ Precautions

- For rear holders, make sure that red button faces toward the rear of vehicle when installed.
 - When mounting, loosen the knob of the rear holder, securely hook the clamp into the horizontal bar, and tighten the knob.
- Be sure not to drop the plate nut.

3. Mount the remaining rear holders to the horizontal bar at 4 to 4 3/4 inches (100 to 120mm) apart.

1. Adjust the height of horizontal bar using the adjuster (refer to page 4), and tighten screw A, B, C, D and mounting screws.

⚠ Precautions

- Make sure that the rod tip does not interfere with the roof air condition unit, etc. and the grip does not touch the tailgate.

2. Attach the cover to the arm.

5 Loading the Rod, Final Adjustment

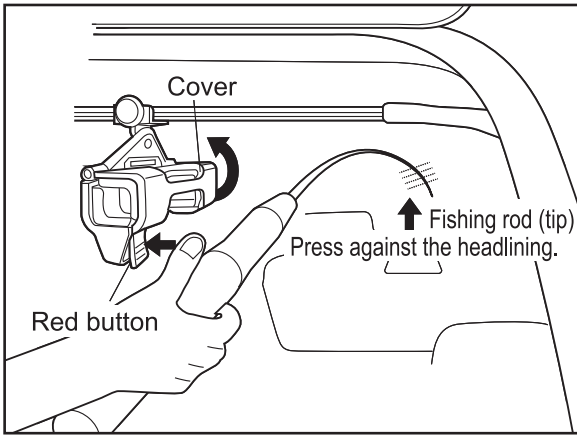

1. Lightly press the fishing rod tip against the headlining, and press the red button of the rear holder to open the cover.

⚠ Precautions

- Handle the rod with care when pressing the rod tip against the headlining, as the rod tip is breakable.

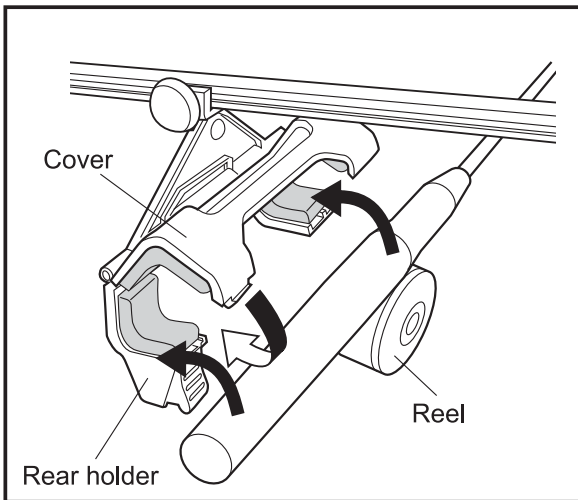

2. Avoiding the reel, place the grip of the rod on the rear holder, and tighten the cover until a click sound is heard.

⚠ Warning

- To avoid the fishing rod sliding forward during hard braking, keep the reel attached to the rod and always keep the reel in the rear holder.

⚠ Precautions

- To keep right and left balanced, load the fishing rods in order from the heaviest to the lightest beginning from the center. When loading only a few fishing rods, always start loading from the center rear holder.

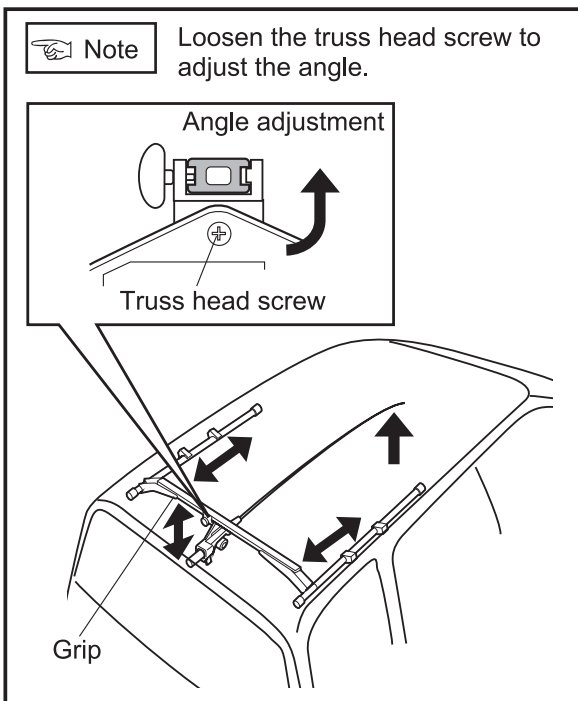

3. Fishing rods should not interfere with the ceiling air condition unit, etc. Make final adjustments to the horizontal bar position height and the rear holder body mounting angle to prevent the grip from touching the closed tailgate.

⚠ Precautions

- The rear holder angle can be adjusted by 10 degrees at a time. Make adjustment so that the fishing rod is not excessively bent. When the fishing rod is not bent at all, the fishing rod tip may bounce during transportation resulting in rod damage.

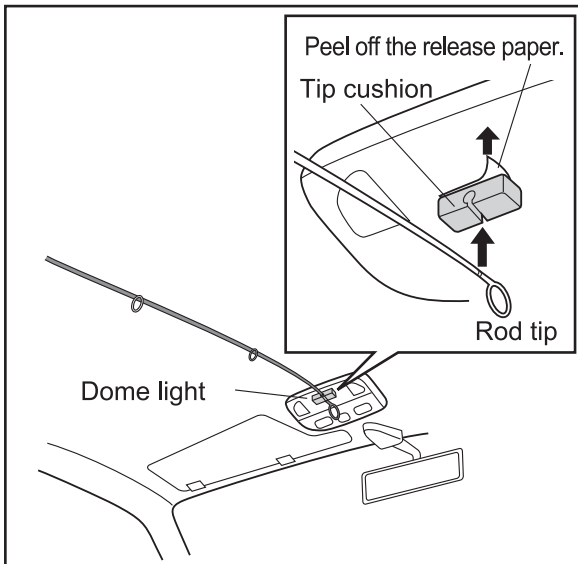

4. If you are concerned about the followings, using the tip cushion may resolve:

- *Rod tip directly touching the headlining.
- *Rod tip interferes with dome light causing a rattling sound while driving

⚠ Precautions

- When the tip cushion is removed, the residue may be left in the headlining. Please note before using it.
- Do not reattach the tip cushion after it has been attached once. Doing so weakens the adhesive strength.

6 How to clean

- Wipe dirt off using a soft damp cloth and dry the product in the shade.
- Doing the following may cause discoloration or cracking of the product. Refrain from using them.
 - Use of detergents (especially alkali detergent) or wax
 - Use of solvents such as thinner
 - Oiling screws or bolts

Repair parts

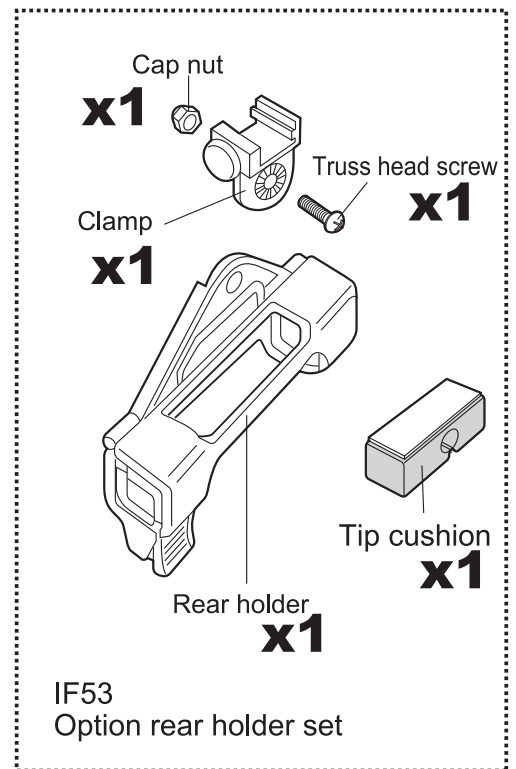
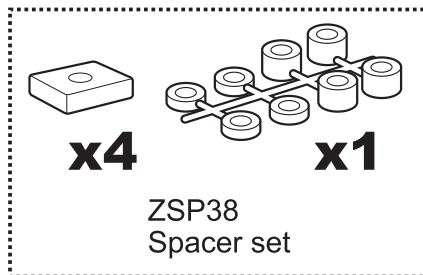
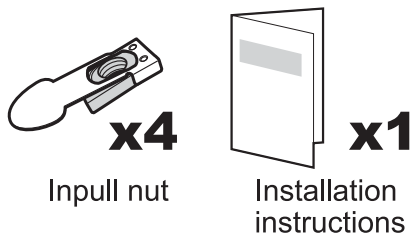
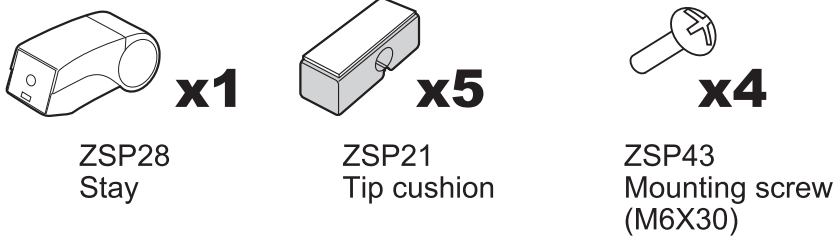
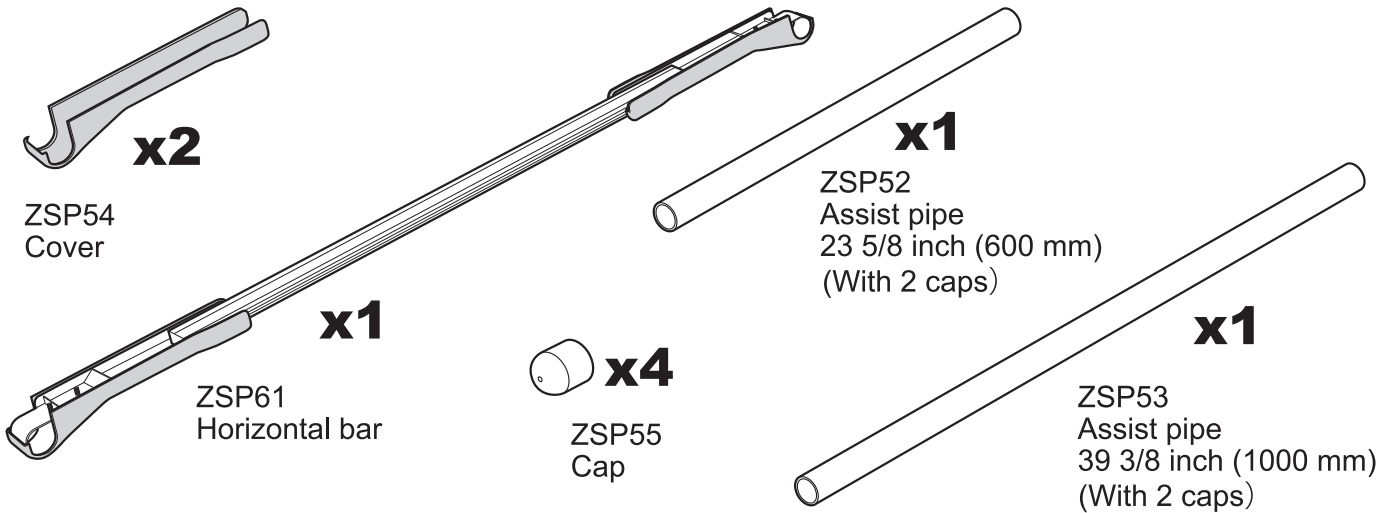

Contact Information

We do not accept any liability for accidents, damage or injury caused by incorrect installation or use, modification, or natural disaster. Specifications and appearance of the carrier system and genuine replacement parts are subject to change without prior notice in the interest of product improvement.

CAR MATE USA, Inc.
383 Van Ness Ave., Suite 1603
Torrance, CA 90501 U.S.A.
support@innoracks.com
www.innoracks.com

CARMATE MFG. CO.,LTD.
5-33-11, Nagasaki, Toshima-ku,
Tokyo 171-0051, JAPAN
TEL.+81(0)3 5926 1226
int@carmate.co.jp