

# ROD HOLDER

## Installation instructions

Before using this product, carefully read this instruction manual for proper use.

Keep this installation instructions in a safe place.

If you are to give this product to a third person, provide him/her with this manual as well to ensure safe use.

IF14

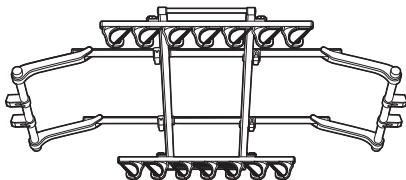

IF16

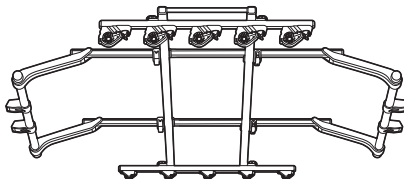

IF17

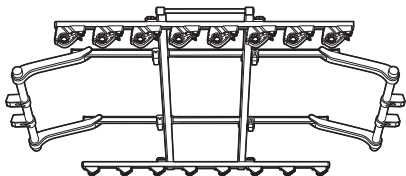

IF18

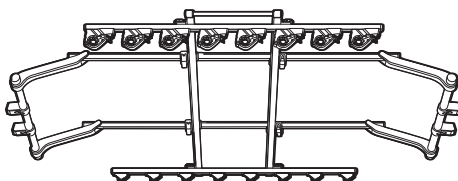

 **Warning** Failure to follow this warning can result in serious accidents including death or serious injury.

- Should a passenger's head contact the rod holder body or rods, the passenger should not sit in that seat.
- To load rods, remove tackle such as hooks and lures or use a commercial lure cover for safety.
- This product is a rod holder for loading rods inside the vehicle. Do not use this product for anything other than its intended purposes.

 **Precautions** Failure to follow precautions can result in injury, damage to the product, vehicle, or load.

- Do not leave rods loaded for extended periods of time. Rods may be damaged by direct sunlight or the internal temperature of the vehicle. Vibrations generated by the vehicle may result in damage or cause the rod or reel to malfunction.
- Rear viewing may be reduced depending on the vehicle model. Exercise caution when backing up the vehicle.
- Always fully tighten before and after driving.
- Maximum load capacity of the frame section: 15.4lbs or 7kg. (For safety, be sure not to exceed maximum load capacity.)

 **Note** Before using this product, the followings should be noted.

- Do not modify this product.

## Product contents

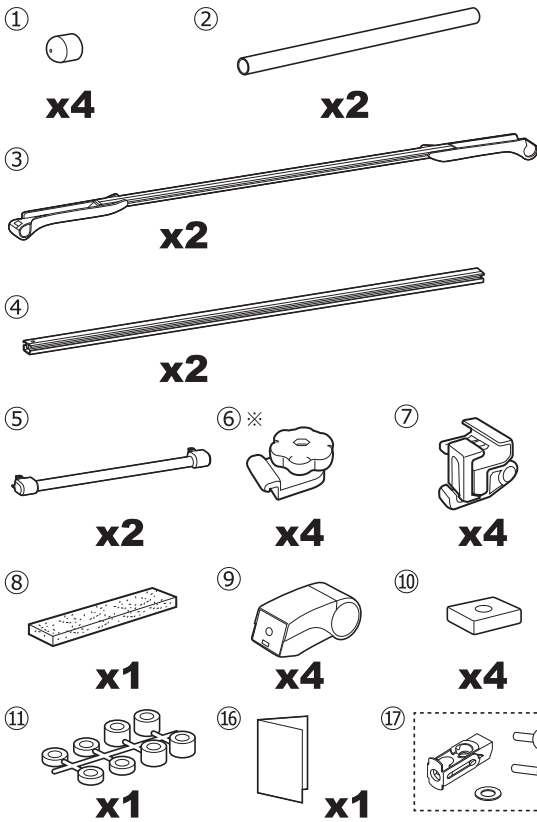

## Common parts

	Parts
①	Cap
②	Assist pipe
③	Horizontal bar
④	Frame bar
⑤	Frame pipe
⑥	Clip set ※
⑦	Cross holder
⑧	Pad
⑨	Stay
⑩	Spacer ①
⑪	Spacer ②・③
⑫	Front Holder
⑬	Rear Holder
⑭	Rubber Band ※
⑮	Frame Molding
⑯	Installation instructions
⑰	Square hole adapter (IF51)

※ Assembled with the holder

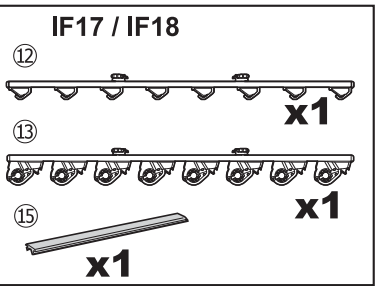
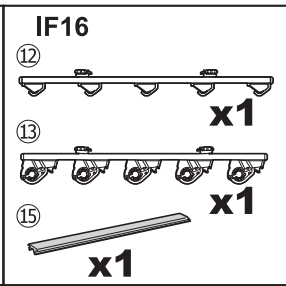
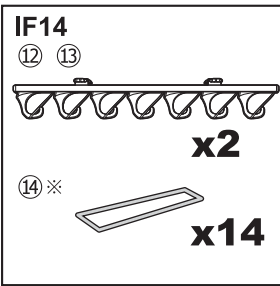

## Necessary Tools for Installation

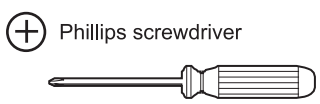

# 1 Assist Pipe Installation

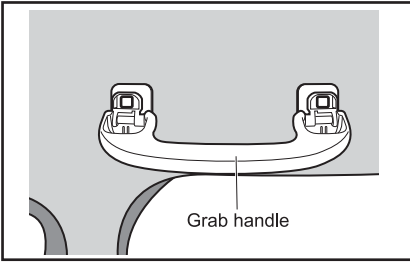

## 1 Remove the second or third seat grab handles.



Note

If unable to remove the grab handle, please contact your dealer for removal instructions.

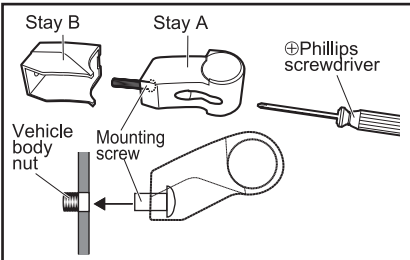

## 2-1 When the grab handle is a screw mounted type

Insert the included mounting screw into Stay A, and put Stay A into Stay B. To temporarily hold the stay on to the vehicle body, insert the mounting screw into the vehicle body nut, then tighten the mounting screw with Philips screwdriver.

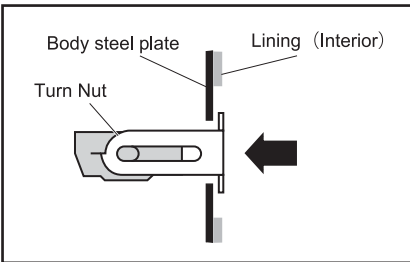

## 2-2 When the grab handle is a square hole fit type

① Insert the turn nut into the square hole of the vehicle as shown in the figure.

② Lightly push it with the screw to rotate the nut section.

③ Pass the included screw through stay A and cover it with stay B. Insert the Phillips screwdriver into the slot of the screw to hold, pass the screw through the spacer and the washer to temporarily fix the stay with the turn nut mounted to the vehicle.

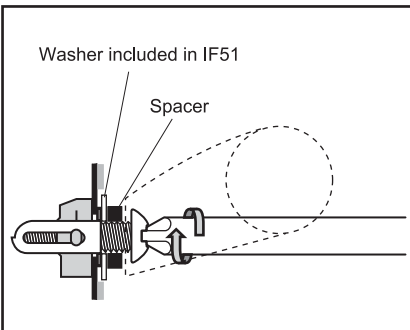
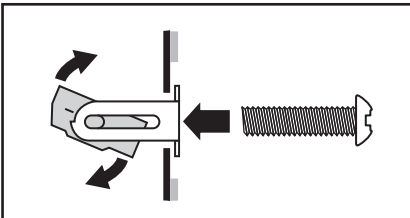

Precautions

Be sure to use the washer included in IF51.



Note

Choose a spacer in accordance with the concave portion and the shape of the vehicle.

### How to choose a screw

Spacer	Screw
0mm or 5mm	M6×30mm
10mm or 15mm	M6×40mm

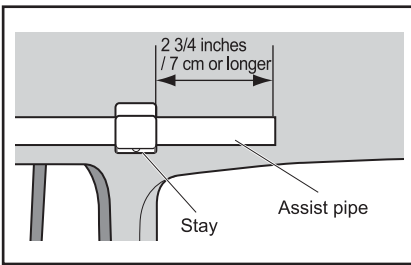

**3** Put the assist pipe through the stay from the side and temporarily fix the stay with the pipe protruding at least 2 3/4 inches or 7 cm. Temporarily tighten the mounting screw to prevent the pipe from rattling but allowing the pipe to slide backward and forward.

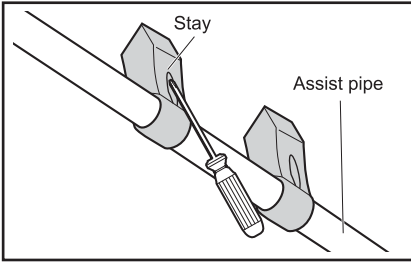
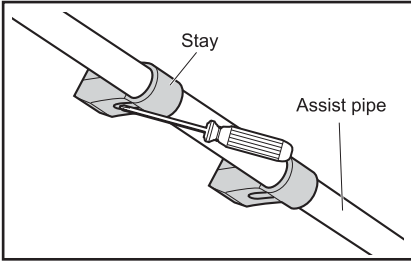

 Note

When the pipe touches the interior or when a hand cannot be inserted in the space between the headlining and the pipe due to lack of room, install the stay upside down or insert Spacer 1 and tighten the screw.

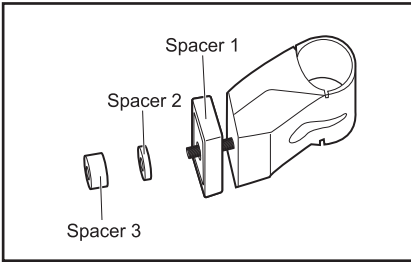

 Note

When the bar is loose due to insufficient tightening with a long screw or when the horizontal bar length is insufficient due to a wide vehicle width, insert Spacer 1 and tighten the screw. If the interior holes are too big and causing rattling, insert Spacer 2 or 3 and tighten the screw.

## 2 How to mount the horizontal bar

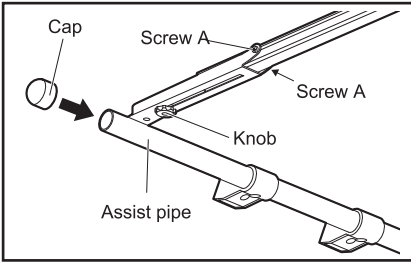

Remove the arm cover and the bracket from the horizontal bar in advance.

**1** Loosen screw A and the knob, and place the arm on the assist pipe.

**2** Affix caps to the assist pipes.

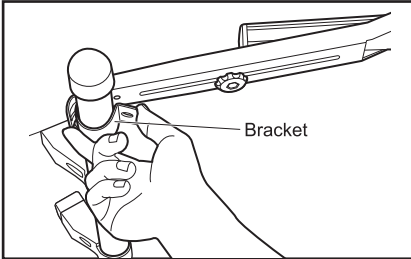

**3** Mount the bracket from below, and temporarily fix in place.

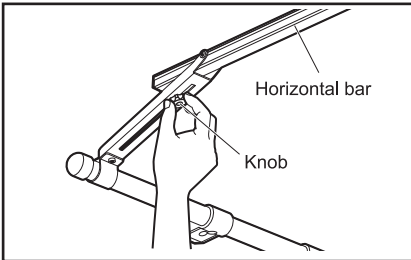

**4** Raise the horizontal bar as high as possible while having the adjuster touch the horizontal bar so that the bar becomes horizontal, and temporarily fix the knob in place.

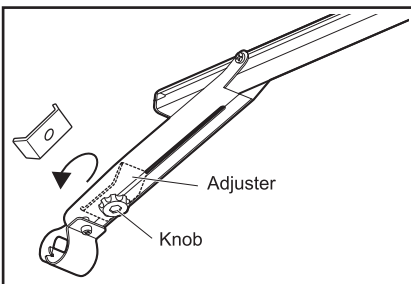
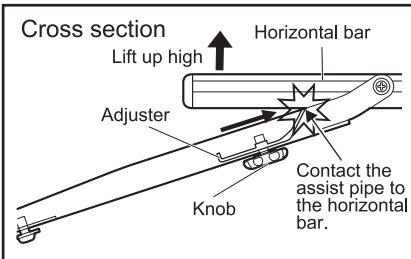

### Note

When the adjuster does not enter below the horizontal bar, take it out, change the direction, and temporarily fix the knob in place.

### 3 Holder Assembly (※Preliminary work is not necessary for the J hook type.)

#### Preliminary work (For dual hold type)

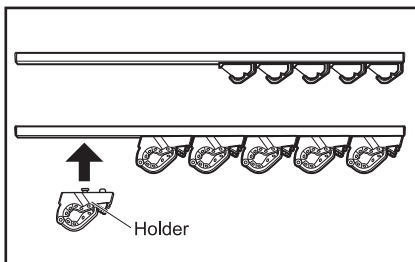

Decide on the number and position of holders based on the purpose.

#### Note

To add a holder, purchase separately sold IF50BK optional holder DH.

#### 【Removing holders】

Rotate the front holder by 90 degrees to remove from the holder frame.

Rotate the rear holder by 90 degrees while pressing the release switch to remove.

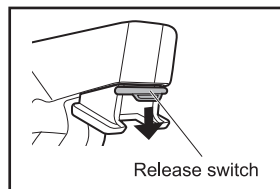
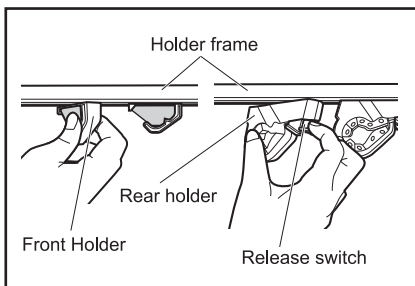

#### 【Mounting holders】

Insert the upper holder at the right angles to the space of the holder frame, and rotate it by 90 degrees to mount.

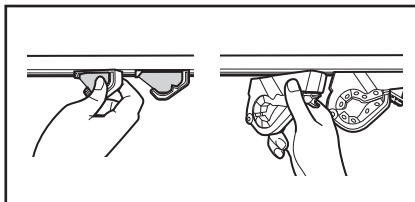

#### 【Mounting frame molding】

Cut the frame molding with scissors to fill in the left space of the holder frame.

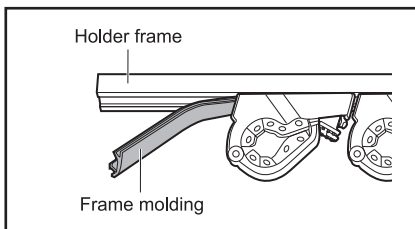

### 4 Assembly of frame bar

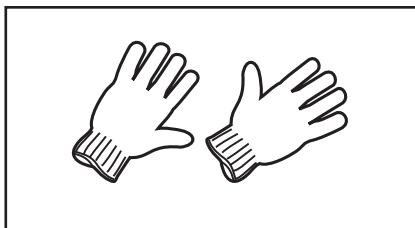

#### Precautions

Always wear gloves when assembling the rack. The aluminum edges may injure your hand or fingers.

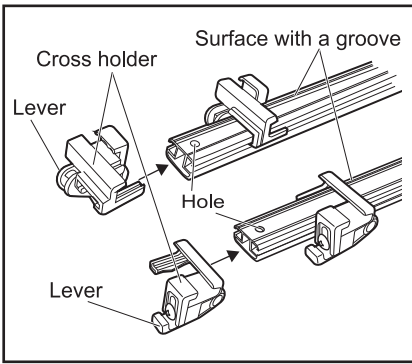

**1** Fit 2 cross holders in the frame bars by making the levers stay outside the frame bars.



Do not mount the levers of the cross holders inside the frame bars. Doing so weakens the fixing strength.



Face the surfaces with holes and grooves of the frame bars up.

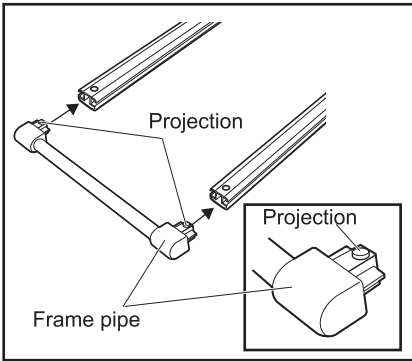

**2** Match the projection of the frame cap to the hole of the frame bar to insert.

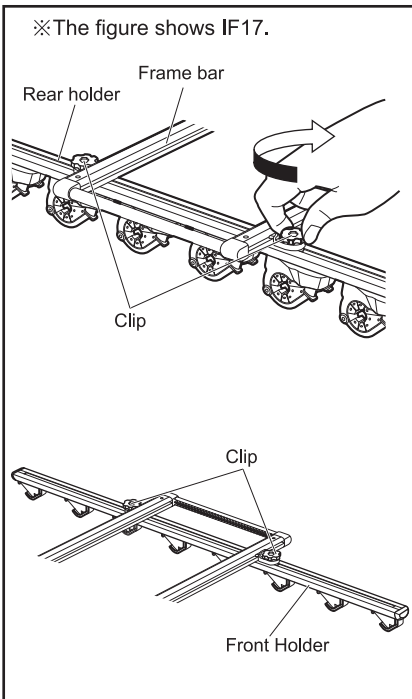

**3** Fix the front and rear holders with clips from outside the frame bars.

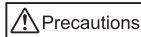

Do not mount the clips inside the frame bars. Doing so weakens the fixing strength.



Mount the holder by facing the groove side of the frame bar up.



For J hook type holders, face the front and rear holder in the reverse direction to mount.

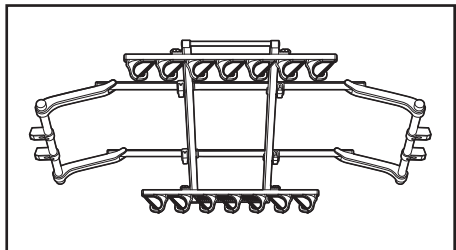

## 5 How to mount frames

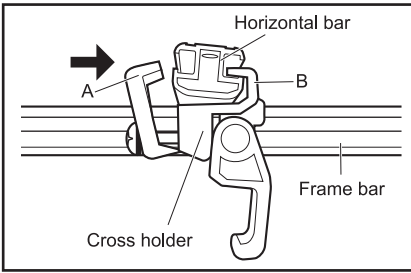

- 1 Loosen the levers in 4 places of the cross holder to move A downward.  
Adjust in front and behind the cross holder, and insert B into the groove of the horizontal bar.

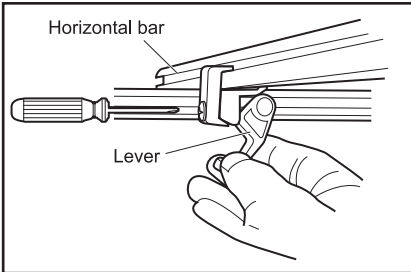

- 2 Raise A to insert into the groove of the horizontal bar, and fasten the lever.

### Note

When the lever is loose or too tight to fasten, adjust the adjustment screw using a Phillips screwdriver.

### Precautions

Do not drive the vehicle with the levers open.

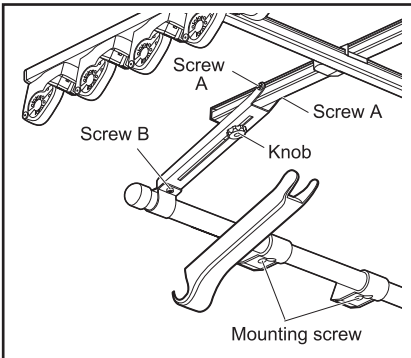

- 3 To adjust the horizontal bar height to make it as high as possible using the adjuster, paste the pad to the place contacting the lining, and tighten all screws.

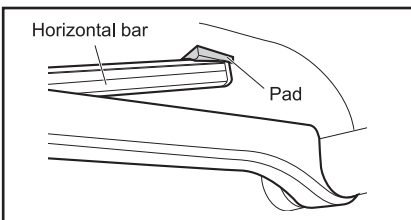

### Note

Cut the included pad and paste it to the contact place between the horizontal bar edge and the lining to reduce the damage to the lining.

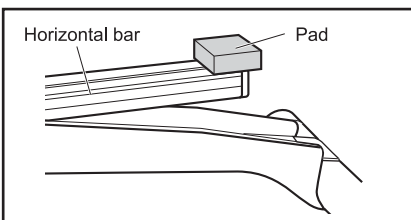



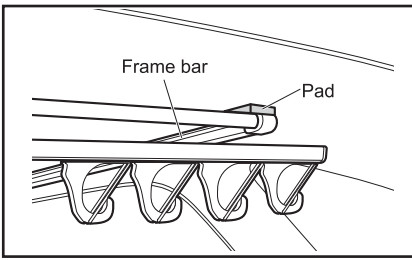

 Note

Depending on the vehicle model, the rear holder edge on rare occasions as well as the frame bar contact the lining. In that case, cut the included pad and paste to the place to which the frame bar or the rear holder contacts.

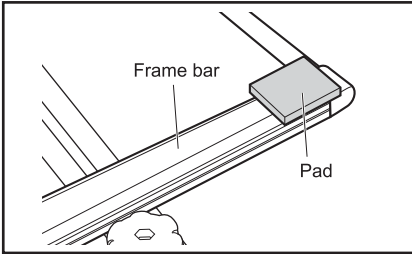

## 6 How to load the rod

For J hook type

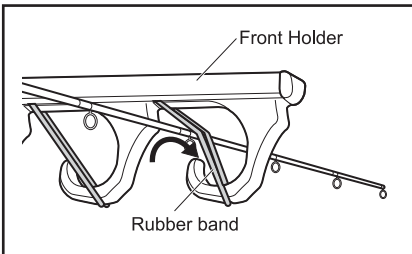

Push the rubber bands in the order of front and rear to hook to the bottom of the hook.

 Note

If the tip is too thin causing rattling when loading the one piece rod, paste the included pad to the hook as shown in the figure.

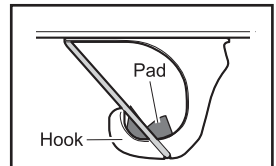
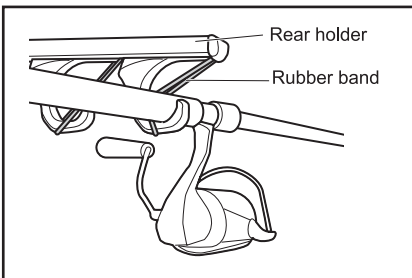

 Precautions

- Fishing rod tips are easily damaged, so handle the rod with care.
- Bundle rod sections with a rod belt, etc. to load jointed fishing rod.
- Apply a cover to the telescopic extension rod end before loading.

## For dual hold type

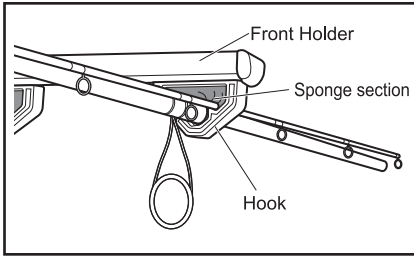

Insert the rod to the sponge section of the front holder.



Standard loading position is the tip side on the right and the grip side on the left.

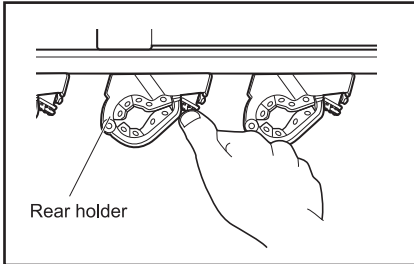
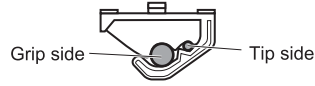

Press the button to open the rear holder. Place the rod, and close it until it clicks.



Standard loading position is the tip side on the right and the grip side on the left.

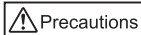
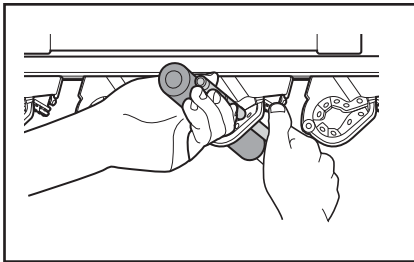
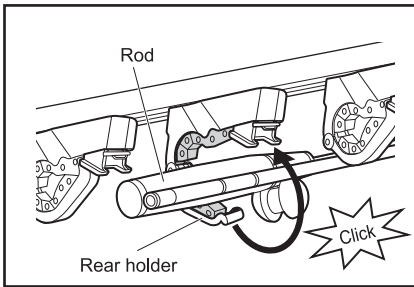
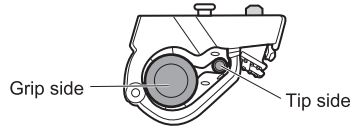

When unloading the rod, always hold the grip end with a hand, and press the button with the other hand to remove. If the button is pressed first, the rod may drop or the product may be damaged.



When reels touch each other, load reels to the front and back of the rear holders alternately.

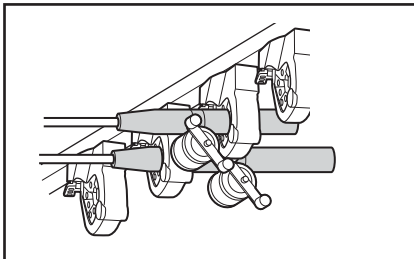

## 7 How to clean

- Wipe dirt off using a soft damp cloth and dry the product in the shade.
- Doing the following may cause discoloration or cracking of the product. Refrain from using them.
  - Use of detergents (especially alkali detergent) or wax
  - Use of solvents such as thinner
  - Oiling screws or bolts

## Repair parts

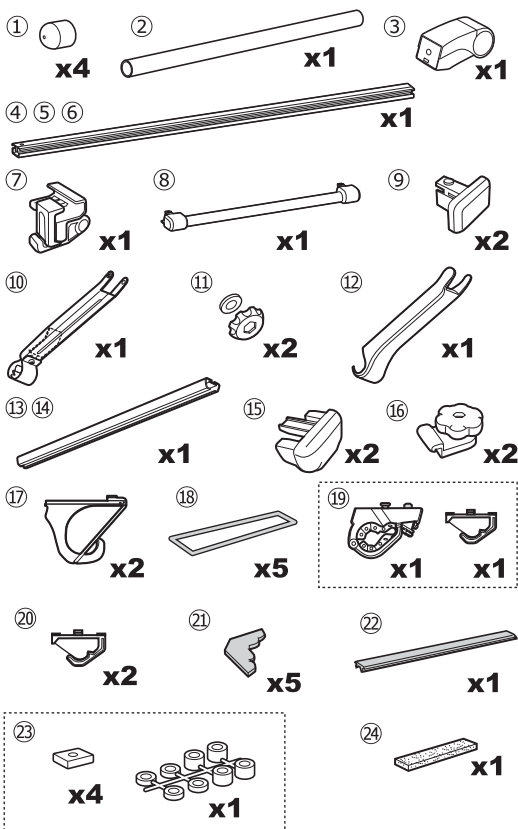
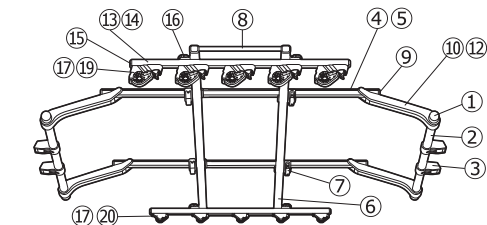

No	Parts
①	ZSP55
②	ZSP52
③	ZSP28
④	ZSP80
⑤	ZSP81
⑥	ZSP82
⑦	ZSP88
⑧	ZSP83
⑨	ZSP84
⑩	ZSP85
⑪	ZSP86
⑫	ZSP87
⑬	ZSP89
⑭	ZSP90
⑮	ZSP92
⑯	ZSP91
⑰	ZSP93
⑱	ZSP24
⑲	IF50BK
⑳	ZSP73
㉑	ZSP74
㉒	ZSP75
㉓	ZSP38
㉔	ZSP94
㉕	IF51

## Contact Information

We do not accept any liability for accidents, damage or injury caused by incorrect installation or use, modification, or natural disaster. Specifications and appearance of the carrier system and genuine replacement parts are subject to change without prior notice in the interest of product improvement.

### **CAR MATE USA, Inc.**

383 Van Ness Ave., Suite 1603  
Torrance, CA 90501 U.S.A.  
support@innoracks.com  
www.innoracks.com

### **CARMATE MFG. CO.,LTD.**

5-33-11, Nagasaki, Toshima-ku,  
Tokyo 171-0051, JAPAN  
TEL.+81(0)3 5926 1226  
int@carmate.co.jp